

**FOR
SALE**

union



PANDORA FRONTAGE

ICONIC OLD TOWN RETAIL INVESTMENT OPPORTUNITY

HIGH VISIBILITY FRONTAGES ON PANDORA AVE & FISGARD ST

FISGARD FRONTAGE



3 UNITS | 5 TENANTS | 10,296 SF | 6.19% CAP RATE (STABILIZED 5-YEAR AVERAGE)

THE OFFERING

CBRE Victoria's Investment Properties Group is pleased to present for sale, 3 retail strata units in the renowned Union development. With frontages on both Pandora Avenue and Fisgard Street in Victoria, BC, this retail portfolio offers a rare opportunity to purchase over 10,000 SF of high-exposure retail in the heart of Old Town. Built in 2014, Union is a mixed-use development featuring 133 residential suites in addition to the 3 commercial units. Investors will benefit from the strong tenant mix, high-exposure location and significant passive investment income in one of Victoria's most iconic and well frequented areas.

HIGHLIGHTS

- + 3 commercial strata units (fully leased to 5 tenants)
- + SL1/SL2 have approx. 115 ft of frontage on Pandora
- + SL3 has approx. 125 ft of frontage on Fisgard
- + Both streets are extremely high exposure corridors
- + High quality modern construction (2014 built)
- + Located in the heart of Victoria's Old Town
- + Consistent year-round foot and vehicle traffic
- + Situated on the ground floor of the renowned 133-unit Union development
- + Abundant street parking available
- + Priced over \$500,000 below assessed value

DETAILS

Civic Addresses	530 Pandora Ave (SL1) 524 Pandora Ave (SL2) 517 Fisgard St (SL3)
PID's	029-264-120 (SL1) 029-264-138 (SL2) 029-264-146 (SL3)
Floor Area	SL1: 2,551 SF SL2: 2,451 SF SL3: 5,294 SF <hr/> Total: 10,296 SF
Year Built	2014
Zoning	OTD-1 Old Town District
Assessed Value	\$6,038,000 (2026 Total)

PRICE: \$5,500,000

CAP RATE: 6.19%

(STABILIZED 5-YEAR AVERAGE)

*Contact agents for lease details



LEASE SUMMARY

Civic Address	518 Pandora Ave	530 Pandora Ave	519 Fisgard St	523 Fisgard St	530 Pandora Ave
Strata Lot #	SL2	SL3	SL3	SL3	SL1 (w/ LCP Patio)
Tenant	SpinCo Victoria	Ohana Poke	La Roux Patisserie	Fan Tan Home & Style	Dough Eyes
Total Area	2,447 SF	1,733 SF	1,364 SF	2,387 SF	2,888 SF

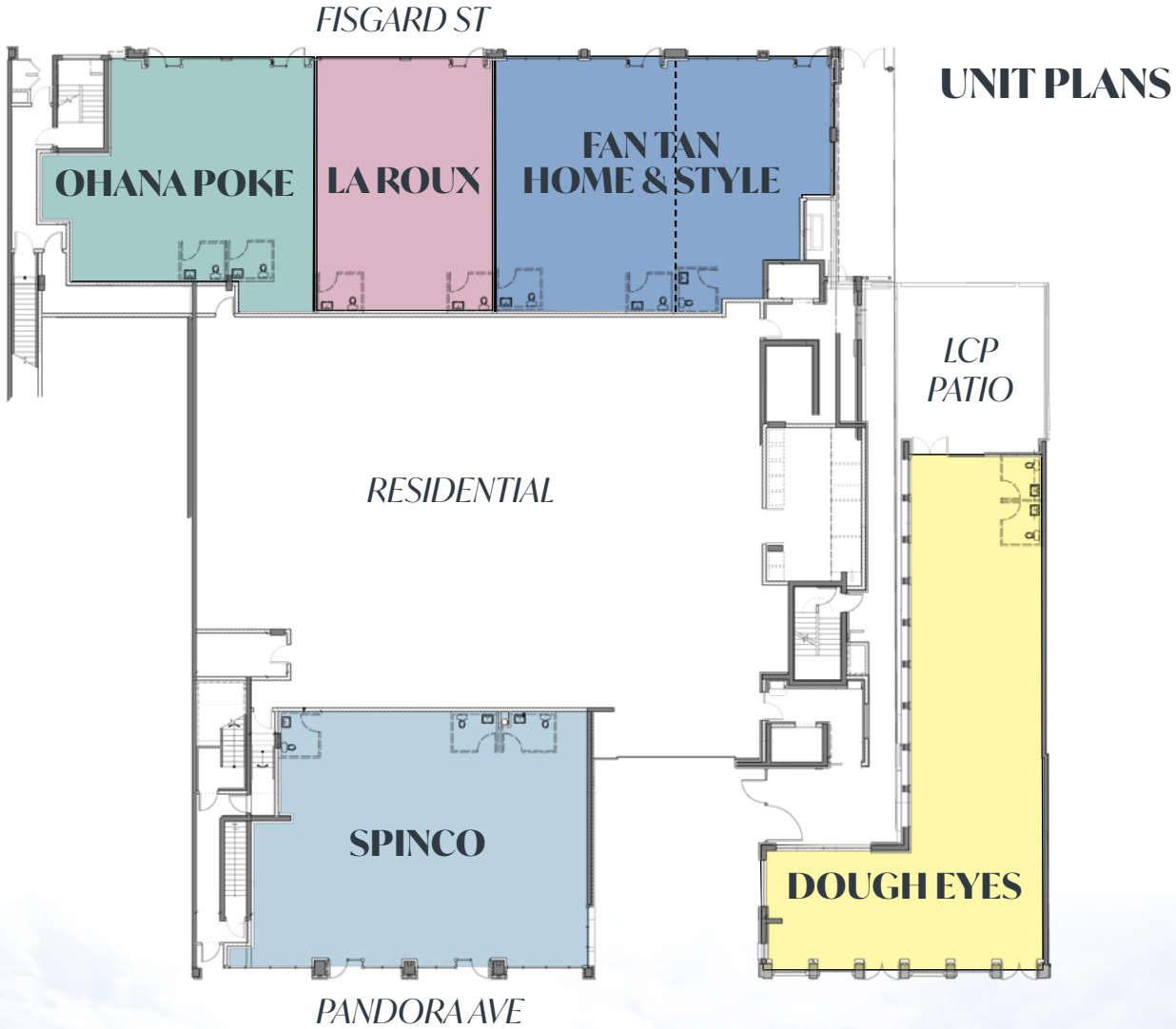

**FOR
SALE**

CBRE

www.cbre.ca
www.cbrevictoria.com

union

PANDORA AVE

GOVERNMENT STREET

FISGARD STREET

PRICE: \$5,500,000

CAP RATE: 6.19%

(STABILIZED 5-YEAR AVERAGE)

ICONIC DOWNTOWN RETAIL INVESTMENT OPPORTUNITY

HIGH VISIBILITY FRONTAGES ON PANDORA AVE & FISGARD ST

EXCLUSIVE ADVISORS:

Chris Rust

Personal Real Estate Corporation
Senior Vice President
Investment Properties Group Victoria
250 386 0005
chris.rust@cbre.com

Ross Marshall

Personal Real Estate Corporation
Senior Vice President
Investment Properties Group Victoria
250 386 0004
ross.marshall@cbre.com

Cooper Anderson

Sales Associate
Investment Properties Group Victoria
250 386 0276
cooper.anderson@cbre.com

CBRE Limited | 110-800 Yates Street, Victoria, BC V8W 1L8 | 250 386 0000

This disclaimer shall apply to CBRE Limited, Real Estate Brokerage, and to all other divisions of the Corporation; to include all employees and independent contractors ("CBRE"). The information set out herein, including, without limitation, any projections, images, opinions, assumptions and estimates obtained from third parties (the "Information") has not been verified by CBRE, and CBRE does not represent, warrant or guarantee the accuracy, correctness and completeness of the Information. CBRE does not accept or assume any responsibility or liability, direct or consequential, for the Information or the recipient's reliance upon the Information. The recipient of the Information should take such steps as the recipient may deem necessary to verify the Information prior to placing any reliance upon the Information. The Information may change and any property described in the Information may be withdrawn from the market at any time without notice or obligation to the recipient from CBRE. CBRE and the CBRE logo are the service marks of CBRE Limited and/or its affiliated or related companies in other countries. All other marks displayed on this document are the property of their respective owners. All Rights Reserved. Mapping Sources: Canadian Mapping Services canadamapping@cbre.com; DMTI Spatial, Environics Analytics, Microsoft Bing, Google Earth.