

FOR LEASE

CBRE

13,493 SF INDUSTRIAL OPPORTUNITY ON 1.1 ACRES

EXCEPTIONALLY WELL-LOCATED IN COMMERCE CIRCLE

751 ENTERPRISE CRESCENT | SAANICH, BC

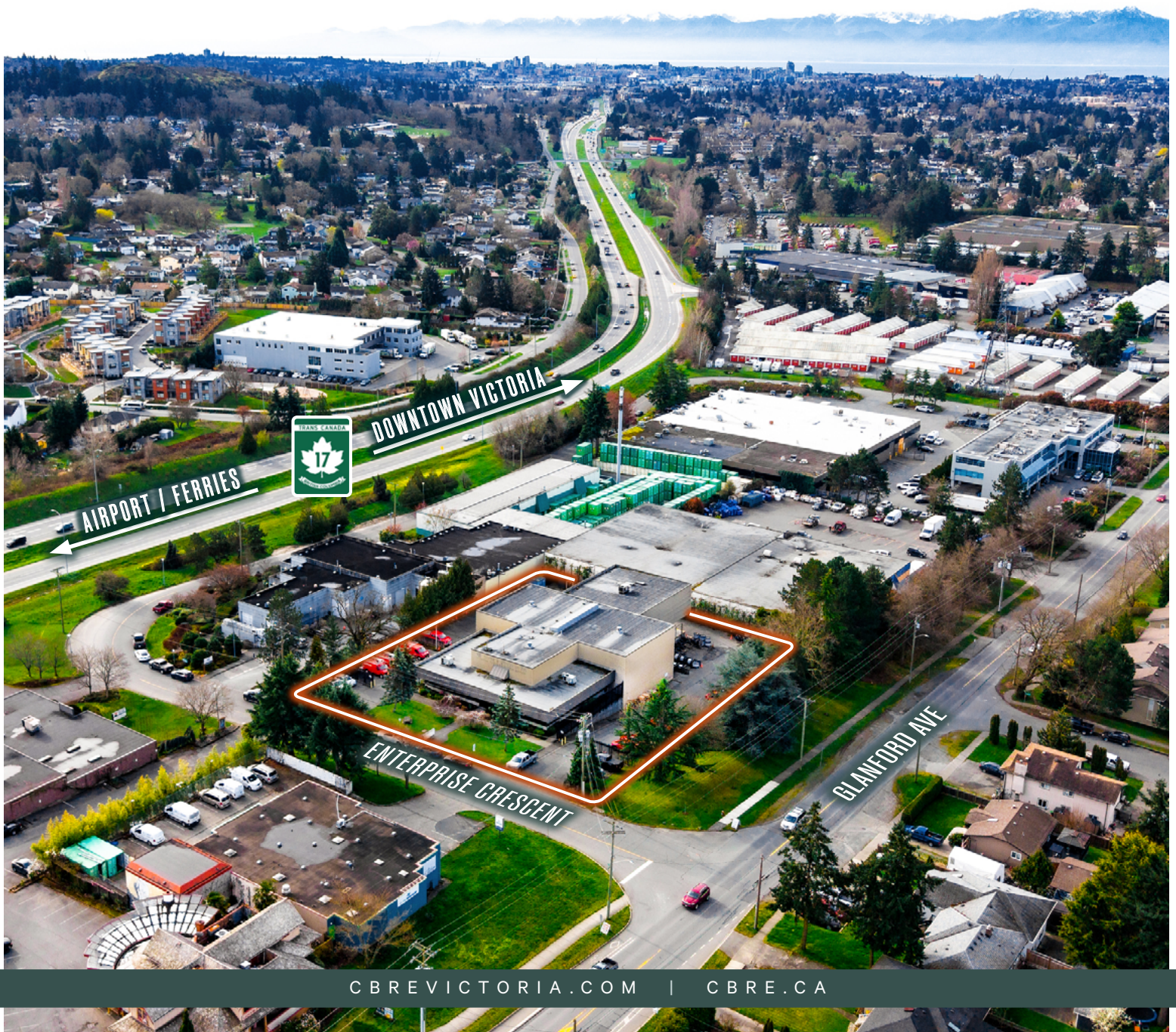

The Offering

CBRE Limited is pleased to offer for lease 751 Enterprise Crescent (the "Property") – an exceptionally well-located 13,493 SF industrial facility on 1.13 acres in the highly desirable Commerce Circle Business Park. The 8,709 warehouse area offers 6 loading docks with cross-deck capability and 27' 8" clear heights. The front of house offers a reception, open workspace, and 3 private offices. The additional steel mezzanine provides two additional open workspaces currently utilized as training rooms. With two access points and 44 surface parking stalls secured with an electric gate, the Property is ideal for a wide range of industrial users. Located one block from Highway 17, it provides convenient servicing to all of Greater Victoria.

Details

Building Size:	Office: 4,744 SF Warehouse: 8,709 SF Total: 13,493 SF
Land Size:	48,470 SF 1.13 Acres
Zoning:	M-3 Industrial Park Zone
Loading:	Five 10' x 12' Overhead Doors (1 Grade, 4 Dock) One 6' x 7' Dock Level Door
Clear Heights:	27'8" Clear in Warehouse
Electrical:	600 Amp 3 Phase
Heat:	Radiant Overhead in Warehouse Electric Baseboard in Office
Parking:	44 Secured Surface Parking Stalls On-Site
Security:	Fully Fenced with Electric Gate
Availability:	Immediately

751 Enterprise Crescent / Saanich, BC

Lease Rate: \$23.00 PSF
Additional Rent: Contact Agents

Highlights

- + 13,493 SF industrial facility on 1.13 acres
- + Exceptional loading with 4 dock level and 2 grade level doors
- + 27' 8" clear heights in warehouse
- + Fully fenced and paved yard with electric gating
- + 44 secured parking stalls on-site
- + Open workspace and 3 private offices in front of house
- + Steel mezzanine with 1,706 SF of additional workspace
- + 600-amp 3-phase electrical
- + Comprehensive M-3 zoning provides wide range of uses
- + Located in the highly desirable Commerce Circle business park
- + Exceptional vehicular access to Highway 17

Zoning: M-3 Industrial Park

Permitted Uses (Including, but not limited to):

- Warehousing
- Wholesaling
- Retail Sales (Incidental)
- Office
- Industry
- Commercial Education
- Research
- Food Processing
- Veterinary Clinic/Hospital
- Cable Hub Site
- Rental and Repair of Household Items, Tools, Appliances, Equipment
- Beverage Container Depot



Floor Plan

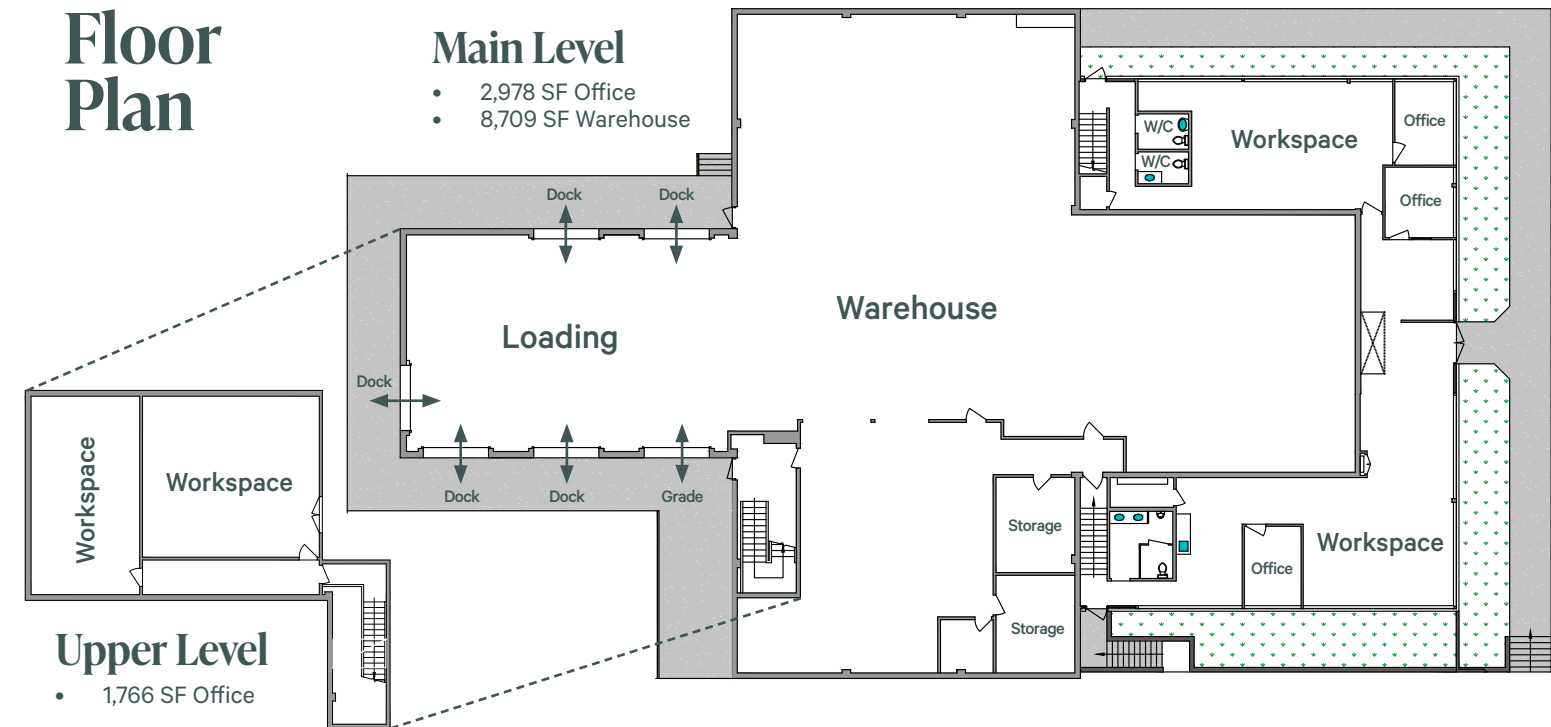

FOR LEASE

13,493 SF INDUSTRIAL OPPORTUNITY ON 1.1 ACRES

EXCEPTIONALLY WELL-LOCATED IN COMMERCE CIRCLE



751 ENTERPRISE CRESCENT | SAANICH, BC

EXCLUSIVE ADVISORS:

CBRE

Ross Marshall

Personal Real Estate Corporation
Senior Vice President
Investment Properties Group Victoria
250 386 0004
ross.marshall@cbre.com

Chris Rust

Personal Real Estate Corporation
Senior Vice President
Investment Properties Group Victoria
250 386 0005
chris.rust@cbre.com

Cooper Anderson

Sales Associate
Investment Properties Group Victoria
250 386 0276
cooper.anderson@cbre.com

CBRE Limited | 110-800 Yates Street, Victoria, BC V8W 1L8 | 250 386 0000

www.cbre.ca
www.cbrevictoria.com

This disclaimer shall apply to CBRE Limited, Real Estate Brokerage, and to all other divisions of the Corporation; to include all employees and independent contractors ("CBRE"). The information set out herein, including, without limitation, any projections, images, opinions, assumptions and estimates obtained from third parties (the "Information") has not been verified by CBRE and CBRE does not represent, warrant or guarantee the accuracy, correctness and completeness of the Information. CBRE does not accept or assume any responsibility or liability, direct or consequential, for the information or the recipient's reliance upon the Information. The recipient of the Information should take such steps as the recipient may deem necessary to verify the Information prior to placing any reliance upon the Information. The Information may change and any property described in the Information may be withdrawn from the market at any time without notice or obligation to the recipient from CBRE. CBRE and the CBRE logo are the service marks of CBRE Limited and/or its affiliated or related companies in other countries. All other marks displayed on this document are the property of their respective owners. All Rights Reserved. Mapping Sources: Canadian Mapping Services canadamapping@cbre.com; DMTI Spatial, Environics Analytics, Microsoft Bing, Google Earth.