

**PRICE
REDUCTION**



FOR SUBLEASE

511 David Street

Units C & D | Victoria, BC

5,850 SF INDUSTRIAL OPPORTUNITY IN ROCK BAY

CBRE



511 David Street

SPACE FEATURES

- + 5,850 SF including mezzanine
- + Reception/warehouse/3 private office on the mezzanine
- + Skylights in warehouse
- + Equipped with alarm system and cameras

\$16.00

SUBLEASE RATE PSF

\$7.50

ADDITIONAL RENT PSF

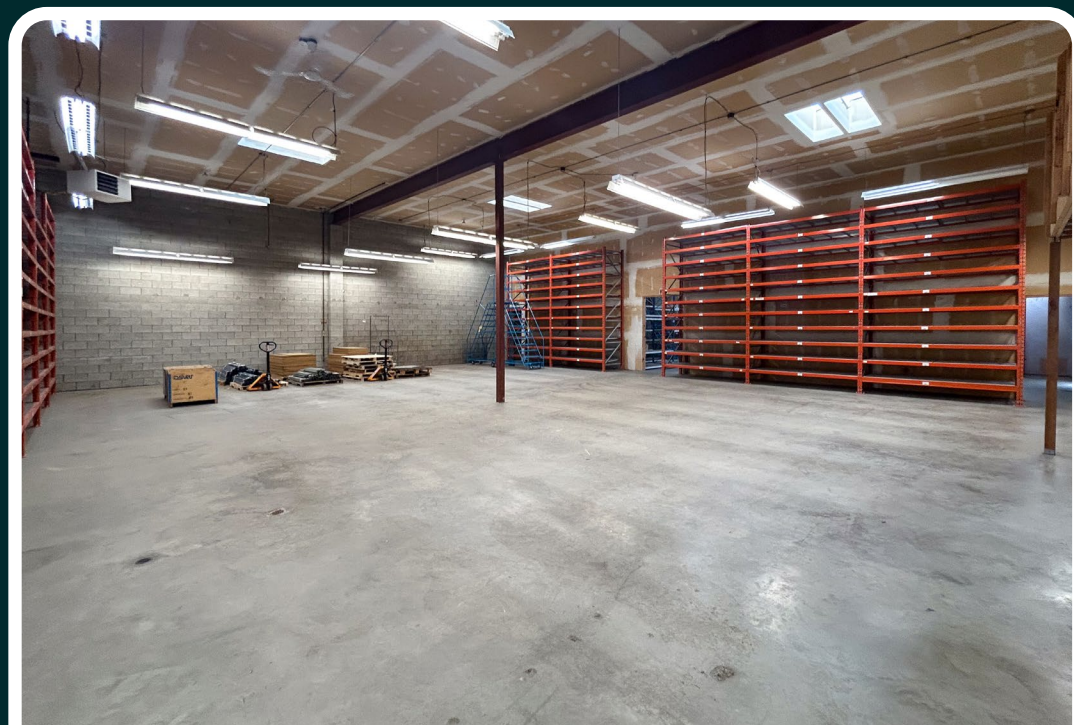

Industrial | For Sublease

CBRE Victoria is pleased to present the opportunity to sublease turnkey warehouse and office space located at 511 David Street in the Rock Bay Industrial hub, just outside downtown Victoria. The premises offers 5,850 square feet across Units C and D, including 500 square feet of mezzanine space, a reception area, three offices, two washrooms, and two 8'x8' grade-level loading doors. Warehouse racking can be included. M-2 Light Industrial District zoning accommodates a broad range of business uses.

Size	5,850 SF (includes 500 SF Mezzanine)
Loading	Two 8'x8' grade level loading doors
Ceiling	18' clear heights
Power	200-amp 3 phase power
Heating	Electric baseboard in offices & overhead gas in warehouse
Parking	3 on-site surface parking stalls
Zoning	M-2 Light Industrial District
Availability	Immediately
Sublease Term	Until January 31, 2029

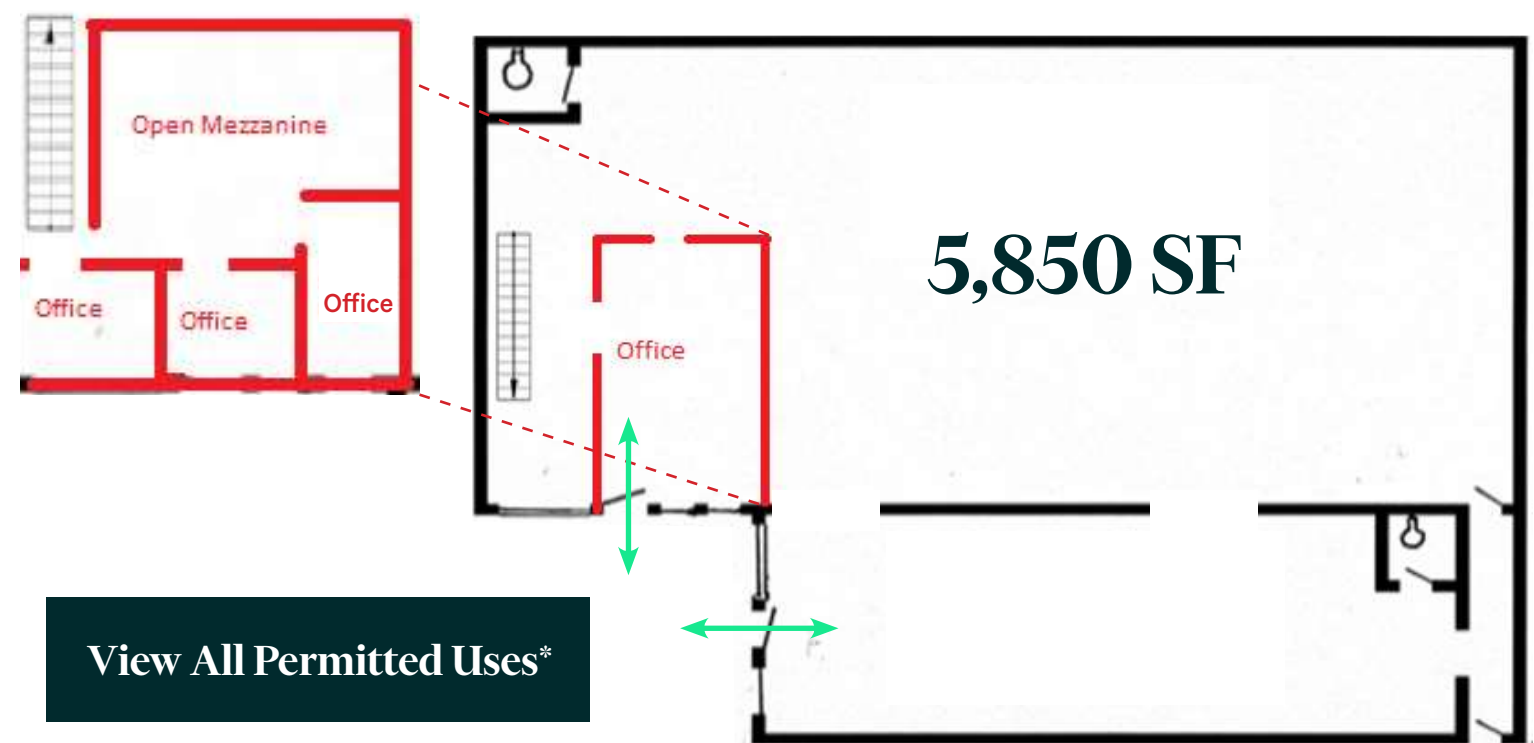

*End user subject to landlord approval.

FOR SUBLEASE

CBRE

511 David Street

Units C & D | Victoria, BC



5,850 SF INDUSTRIAL OPPORTUNITY IN ROCK BAY

CONTACT US

Andrea Teahen

Senior Associate
andrea.teahen@cbre.com
250 813 3377

Ross Marshall

Personal Real Estate Corporation
Senior Vice President
ross.marshall@cbre.com
250 386 0004

Cooper Anderson

Associate
cooper.anderson@cbre.com
250 386 0276

CBRE Limited | www.cbrevictoria.com | 110-800 Yates Street, Victoria, BC, V8W 1L8 | 250 386 0000

This disclaimer shall apply to CBRE Limited, Real Estate Brokerage, and to all other divisions of the Corporation; to include all employees and independent contractors ("CBRE"). The information set out herein, including, without limitation, any projections, images, opinions, assumptions and estimates obtained from third parties (the "Information") has not been verified by CBRE, and CBRE does not represent, warrant or guarantee the accuracy, correctness and completeness of the Information. CBRE does not accept or assume any responsibility or liability, direct or consequential, for the Information or the recipient's reliance upon the Information. The recipient of the Information should take such steps as the recipient may deem necessary to verify the Information prior to placing any reliance upon the Information. The Information may change and any property described in the Information may be withdrawn from the market at any time without notice or obligation to the recipient from CBRE. Content contained in this material has been generated in whole or in part by or with the assistance of generative artificial intelligence. CBRE and the CBRE logo are the service marks of CBRE Limited and/or its affiliated or related companies in other countries. All other marks displayed on this document are the property of their respective owners. All Rights Reserved. Mapping Sources: Canadian Mapping Services canadamapping@cbre.com; DMTI Spatial, Envirionics Analytics, Microsoft Bing, Google Earth.