

RETAIL | FOR LEASE

CBRE



Join Langford's Newest Master Planned Community

Retail Space
3,435 - 7,343 SF

1100 MCCALLUM ROAD

1100

1100 MCCALLUM ROAD

CBRE Limited is pleased to present 1100 McCallum Road, offering 3,435 square feet up to 7,343 square feet of brand new retail space in Langford's newest master-planned community. The subject property will come equipped with 400 AMP power and ample on-site parking.

This unit is part of a six-phase master-planned community, with phase one consisting of four buildings and approximately 600 residential units. In addition to the residential density and future growth, this location benefits from easy access to and from the Trans-Canada Highway, allowing for customers and clientele to conveniently visit the site from all areas of Greater Victoria. The community is zoned MUE3, allowing for a wide range of business uses.

HIGHLIGHTS

- + On-site parking
- + Strong drive by traffic
- + Prominent signage opportunities
- + 600 residential units on-site
- + Easily accessible from the Trans Canada Hwy

3,435 - 7,343 SF

SIZE

Q3 2026

ANTICIPATED COMPLETION



1100 MCCALLUM ROAD

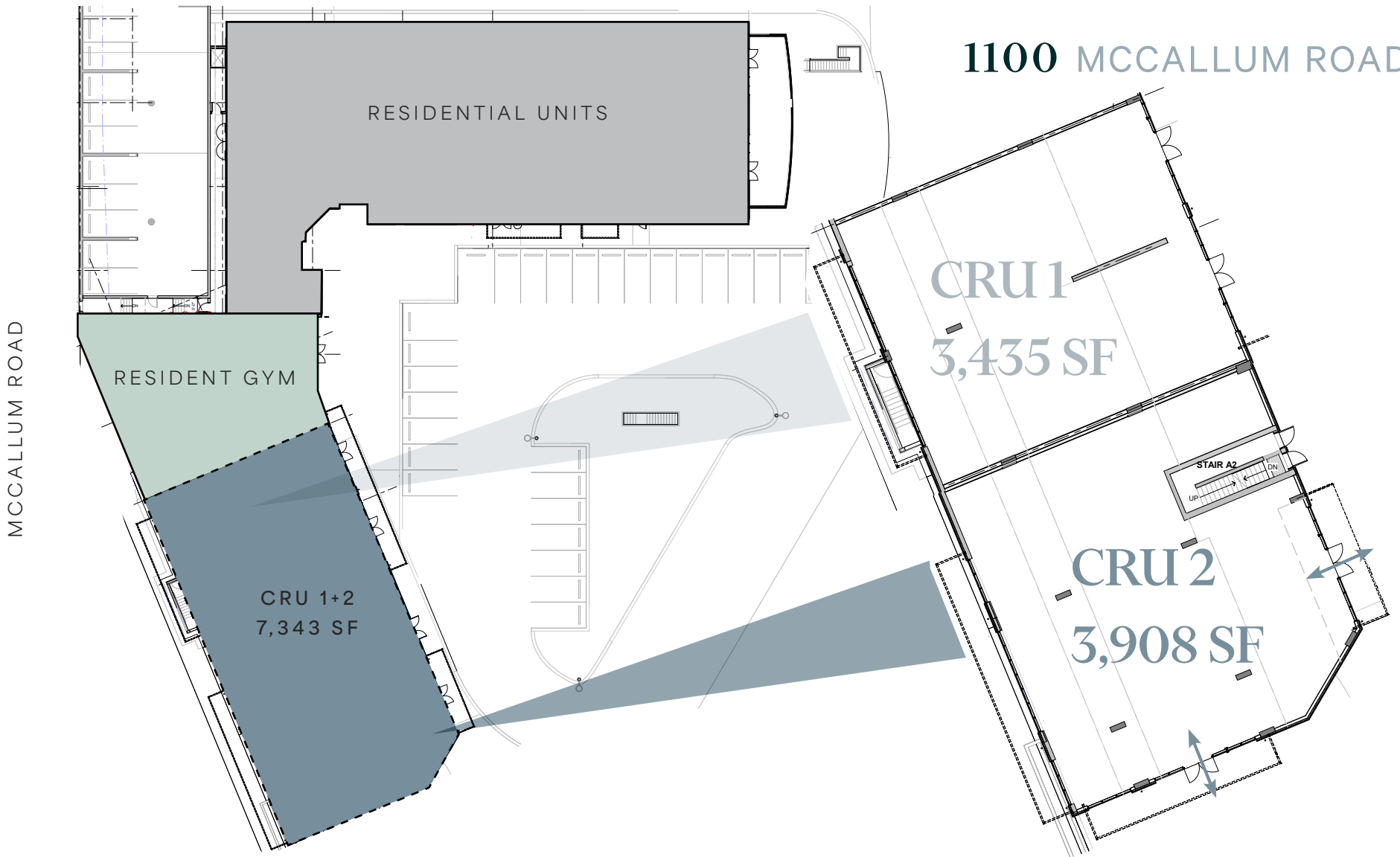

LEASE RATE \$35.00 PSF

ZONING

MUE3: Mixed Use
Employment

PARKING

25 on-site surface parking
stalls

ADDITIONAL RENT \$20.00 PSF

ESTIMATED
COMPLETION

Q3 2026

TOTAL AVAILABLE

7,343 SF

AREA OVERVIEW

Located in Langford, one of the fastest growing communities in Canada, this area is home to many vibrant local businesses and attractions, including Pacific FC, Bear Mountain Recreation Centre, and Langford Lanes. Downtown Langford and Millstream Village, with shops, restaurants, and entertainment options, are just a 5-minute drive away. The proximity to outdoor recreation, like hiking, trails, and parks, further enhances the appeal of this dynamic and desirable location.

1KM RADIUS

22.10%

5YR POPULATION GROWTH RATE

6,088

TOTAL POPULATION

\$110,164

AVERAGE HOUSEHOLD INCOME

112

OF BUSINESSES

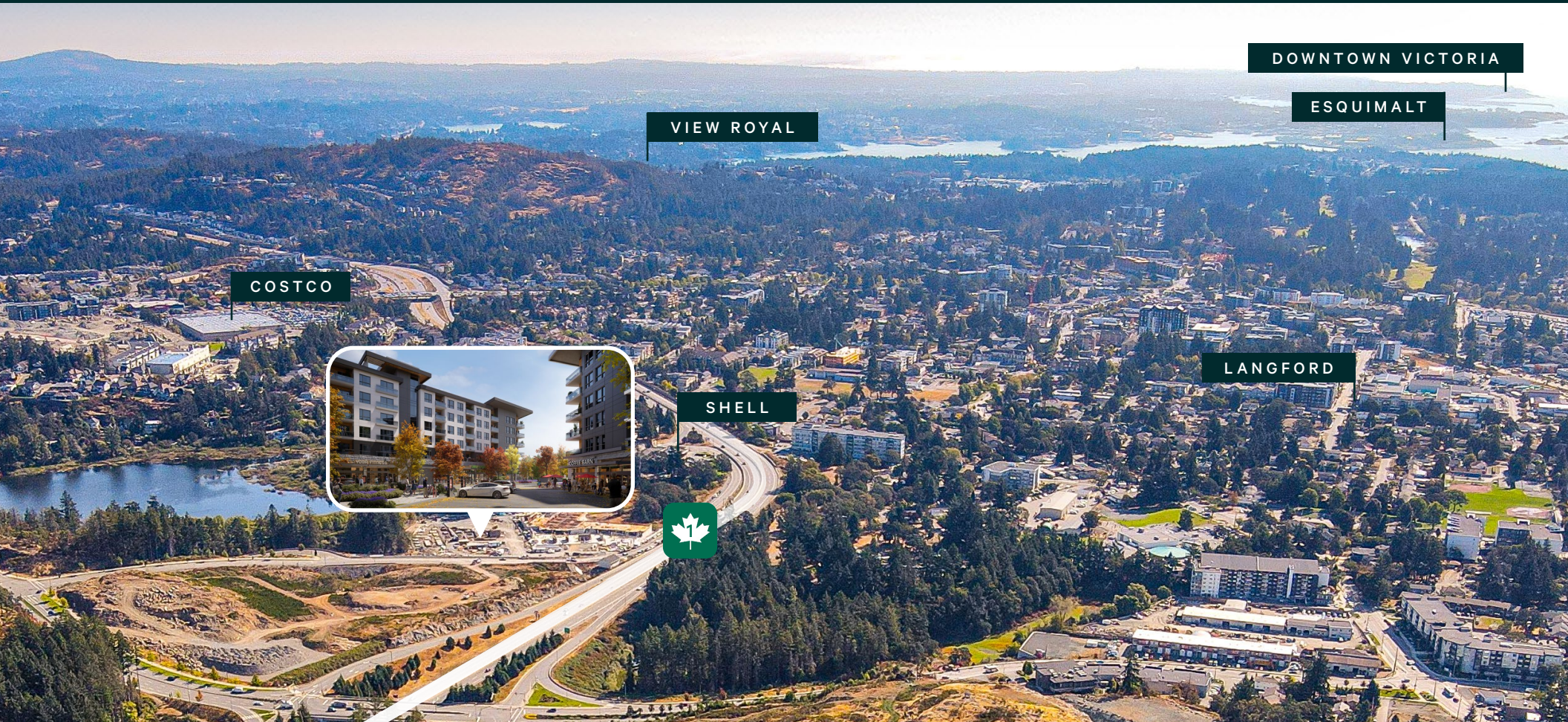

Join Langford's Newest Master Planned Community

1100



MITCH BRYAN
Associate
250 385 1225
mitch.bryan@cbre.com

JEFF LOUGHEED
Vice President
250 386 0001
jeff.lougheed@cbre.com



CBRE Limited | www.cbrevictoria.com | 110-800 Yates Street, Victoria BC, V8W 1L8 | 250 386 0000

© 2024 CBRE, Inc. All rights reserved. This information has been obtained from sources believed reliable but has not been verified for accuracy or completeness. CBRE, Inc. makes no guarantee, representation or warranty and accepts no responsibility or liability as to the accuracy, completeness, or reliability of the information contained herein. You should conduct a careful, independent investigation of the property and verify all information. Any reliance on this information is solely at your own risk. CBRE and the CBRE logo are service marks of CBRE, Inc. All other marks displayed on this document are the property of their respective owners, and the use of such marks does not imply any affiliation with or endorsement of CBRE. Photos herein are the property of their respective owners. Use of these images without the express written consent of the owner is prohibited.