



Grocery Anchored Retail Opportunities For Lease

1008 PANDORA AVENUE | VICTORIA, BC

bosa
properties

CBRE



Site Plan

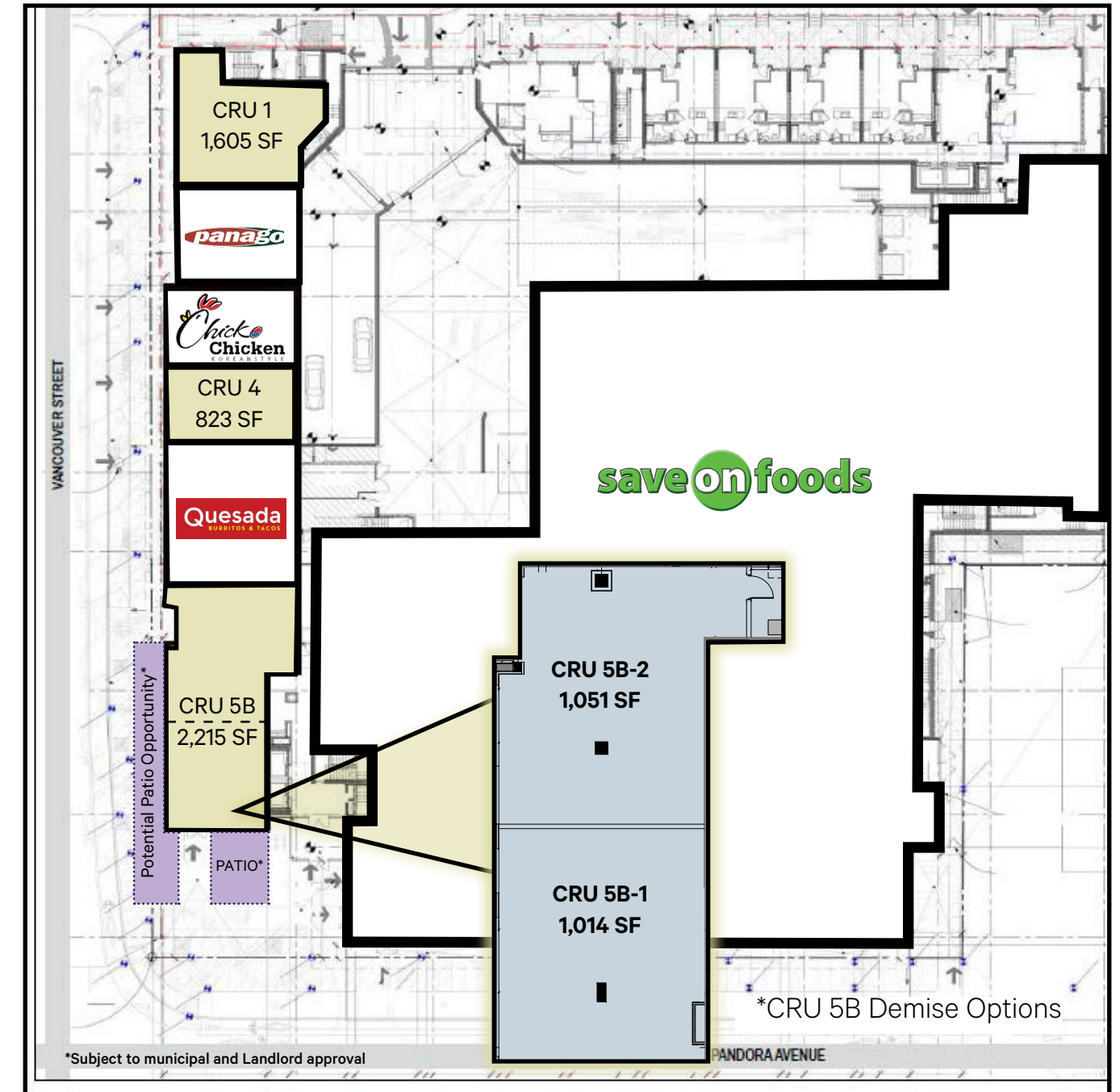

Highlights

- ✓ Grocery anchored by Save-On-Foods
- ✓ 158 on-site parking stalls
- ✓ Flexible CA-75 zoning
- ✓ Prominent signage exposure
- ✓ Generous TI allowance for qualified tenants
- ✓ Excellent walk, bike, & transit scores

Opportunity

Built in 2020, 1008 Pandora Avenue boasts the opportunity to lease prime commercial space in a high-traffic area. With flexible CA-75 zoning and units ranging from 823-2,215 SF, the subject property can accommodate a variety of retail, office, and service-based businesses. These units offer excellent frontage along Pandora Avenue and Vancouver Street and are well-positioned to reach a wide range of clientele. With on-site parking, prominent signage opportunities, and easy accessibility, the opportunity to lease at 1008 Pandora Avenue offers business growth, customer convenience, and effective brand exposure.

Details

AVAILABLE AREA	CRU 1	1,605 SF
	CRU 4	823 SF
	CRU 5B	1,014-2,215 SF
LEASE RATE	\$20.00 PSF	
ADDITIONAL RENT	\$24.31 PSF	
AVAILABILITY	Immediately	
ZONING	CA-75 Pandora Vancouver Mixed Use District	

Tenant Improvement Allowance*

- 5 year term - \$50 PSF**
- 10 year term - \$80 PSF**

*Available for qualified tenants.



1008 Pandora Avenue
Victoria, BC

Location

★ **Subject**
1008 Pandora Avenue, Victoria, BC

● Cafes + Restaurants

1. McDonald's
2. Quesada Burritos & Tacos
3. Panago
4. Sun Wah Chinese Restaurant
5. Bold Butchery & Grill
6. Jones Bar-B-Que
7. Fern Cafe and Bakery
8. Superbaba
9. Nor. Coffee
10. Boomtown
11. Moxies
12. Bin 4 Burger Lounge

● Shopping + Services

1. Save-On-Foods
2. Cook Street Castle
3. The Fitness Academy
4. Forge Training
5. Vic City Barbers
6. RITUAL Nordic Spa
7. Status Barber Shop
8. Bid O Tires
9. Market On Yates
10. Bosley's
11. London Drugs
12. Frontrunners Footwear

New & Upcoming Developments



97



Daily errands do not require a car.

90



Transit convenient for most trips.

97



Daily errands can be accomplished on a bike.

SOURCE: WALKSCORE.COM

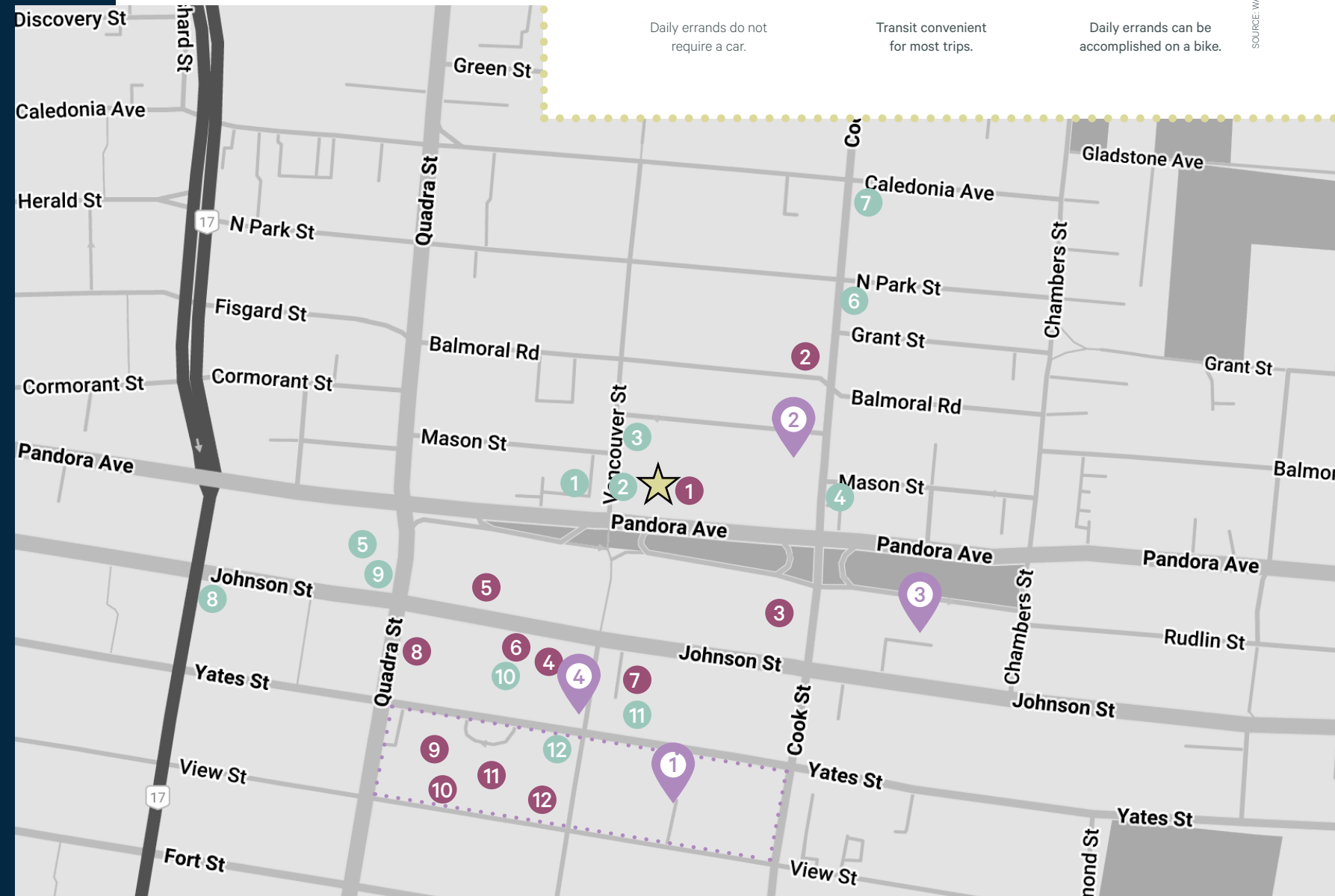



Contact Us

Jeff Lougheed

Vice President

jeff.lougheed@cbre.com

250 386 0001

Mitch Bryan

Sales Associate

mitch.bryan@cbre.com

250 385 1225



CBRE Limited | www.cbrevictoria.com 110-800 Yates Street, Victoria BC, V8W 1L8 | 250 386 0000

© 2021 CBRE, Inc. All rights reserved. This information has been obtained from sources believed reliable, but has not been verified for accuracy or completeness. You should conduct a careful, independent investigation of the property and verify all information. Any reliance on this information is solely at your own risk. CBRE and the CBRE logo are service marks of CBRE, Inc. All other marks displayed on this document are the property of their respective owners, and the use of such logos does not imply any affiliation with or endorsement of CBRE. Photos herein are the property of their respective owners. Use of these images without the express written consent of the owner is prohibited.