

For Lease

Flagship Downtown Retail Opportunity

1420 Douglas Street | Victoria, BC

6 months basic rent free for qualified tenants!



*Conceptual Storefront Glazing

The Offering

Introducing a rare opportunity to lease a prominent flagship retail space located in the heart of Downtown Victoria along Douglas Street. This property boasts high foot traffic, excellent visibility, and potential for an upgraded modern storefront, making it the ideal location for brands looking to make a statement. With generous square footage and customizable interior options, the space is suitable for a variety of retail concepts. Surrounded by popular restaurants and shopping destinations, this flagship location promises to attract a diverse clientele and drive sales. Don't miss on your chance to establish your brand in this prime location!

- + Flagship Downtown Victoria location provides elite visibility and brand recognition
- + 67 feet of premier high-traffic Douglas Street frontage
- + Significant scale with 6,249 SF of ground floor retail space & additional 5,000 SF of lower storage
- + Exceptional signage opportunity
- + Retail area in shell condition, providing flexibility to fixture as desired
- + Rear loading at grade accessible via Pandora Ave
- + Street parking available directly in front of building and one block from multiple parkades

Details

Leasable Area

6,249 SF Main Level
5,000 SF Lower Level Storage

Zoning

OTD-1 - Old Town District 1

Parking

Street Parking / Johnson Street Parkade

Retail Frontage

67' (Approx.)

Ceiling Heights

11'3"

Availability

Immediately

Lease Rate

Contact Agents

Additional Rent

\$13.00 PSF (Approx.)

1420 Douglas Street / Victoria, BC



*Conceptual Storefront Glazing

Floor Plan

Flexible & Open Ground Floor Retail Space

The main floor retail space is currently in shell condition, providing tenants with the opportunity to modernize and refinish the space to suit their business concept.

Contact agents to discuss fixturing

OTD-1 Zone Permitted Uses

Include, but are not limited to:

- Retail
- Office
- Assembly
- Financial Service
- Personal Service
- Food & Beverage Service
- Cultural Facility

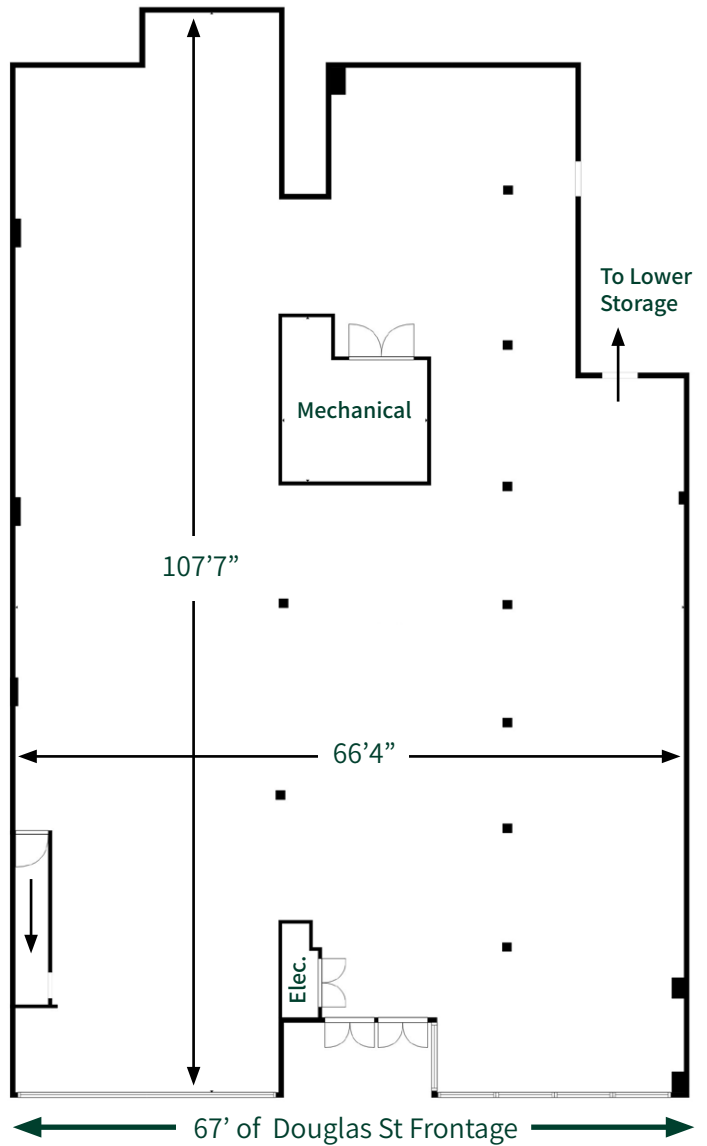

Retail Space (Conceptual Mock-Up)

For Lease



1420 Douglas Street



Flagship Downtown Retail Opportunity

EXCLUSIVE ADVISORS:

Jeff Lougheed
Vice President
Retail Advisory
250 386 0001
jeff.lougheed@cbre.com

Cooper Anderson
Sales Associate
Investment Properties Group
Victoria
250 386 0276
cooper.anderson@cbre.com

Ross Marshall
Personal Real Estate Corporation
Senior Vice President
Investment Properties Group Victoria
250 386 0004
ross.marshall@cbre.com



www.cbre.ca

www.cbrevictoria.com

CBRE Limited | 110-800 Yates Street, Victoria, BC V8W 1L8 | 250 386 0000

This disclaimer shall apply to CBRE Limited, Real Estate Brokerage, and to all other divisions of the Corporation; to include all employees and independent contractors ("CBRE"). The information set out herein, including, without limitation, any projections, images, opinions, assumptions and estimates obtained from third parties (the "Information") has not been verified by CBRE, and CBRE does not represent, warrant or guarantee the accuracy, correctness and completeness of the Information. CBRE does not accept or assume any responsibility or liability, direct or consequential, for the Information or the recipient's reliance upon the Information. The recipient of the Information should take such steps as the recipient may deem necessary to verify the Information prior to placing any reliance upon the Information. The Information may change and any property described in the Information may be withdrawn from the market at any time without notice or obligation to the recipient from CBRE. CBRE and the CBRE logo are the service marks of CBRE Limited and/or its affiliated or related companies in other countries. All other marks displayed on this document are the property of their respective owners. All Rights Reserved. Mapping Sources: Canadian Mapping Services canadamapping@cbre.com; DMTI Spatial, Enviroics Analytics, Microsoft Bing, Google Earth.