

1221

Government St

Downtown Victoria, BC

For Lease



3,774 SF of Main Floor Retail + Additional Basement Area

Prime Retail Space on Government St

- Optimal Location at Intersection of Government Street Shopping Corridor and Trounce Alley Dining & Entertainment Area
- Popular Destination for Tourists & Locals Providing High Foot Traffic Counts Year Round
- 53 Feet of Government Street Frontage
- High Ceilings Throughout the Premises
- High Profile Signage Opportunity
- Situated Amongst Wide Variety of Successful National & Local Retailers

The Opportunity

CBRE Victoria is pleased to present the opportunity to lease premier retail space in the iconic W & J Wilson Building in the Government Street shopping precinct at famous Trounce Alley. The premises can be leased separately or combined for a total of 3,716 SF of main floor space.

The 1200-block of Government Street benefits from high foot-traffic counts year-round, especially in peak tourism season, where it becomes one of the busiest blocks in the city.

This location is the best of both worlds as it is a popular location for tourists & locals. Neighbouring businesses include The Bay Centre, Lush, Lugaro Jewellers, Munro's Books, The Churchill, Bard & Banker, Irish Times Pub, Quazar's Arcade, Eddie Bauer, Roots, Starbucks, Patagonia, Arc'teryx, Mountain Equipment Co-op, Lululemon, and more!



Trounce Alley

View of Government St/Bastion Square From Entrance

Floor Plan

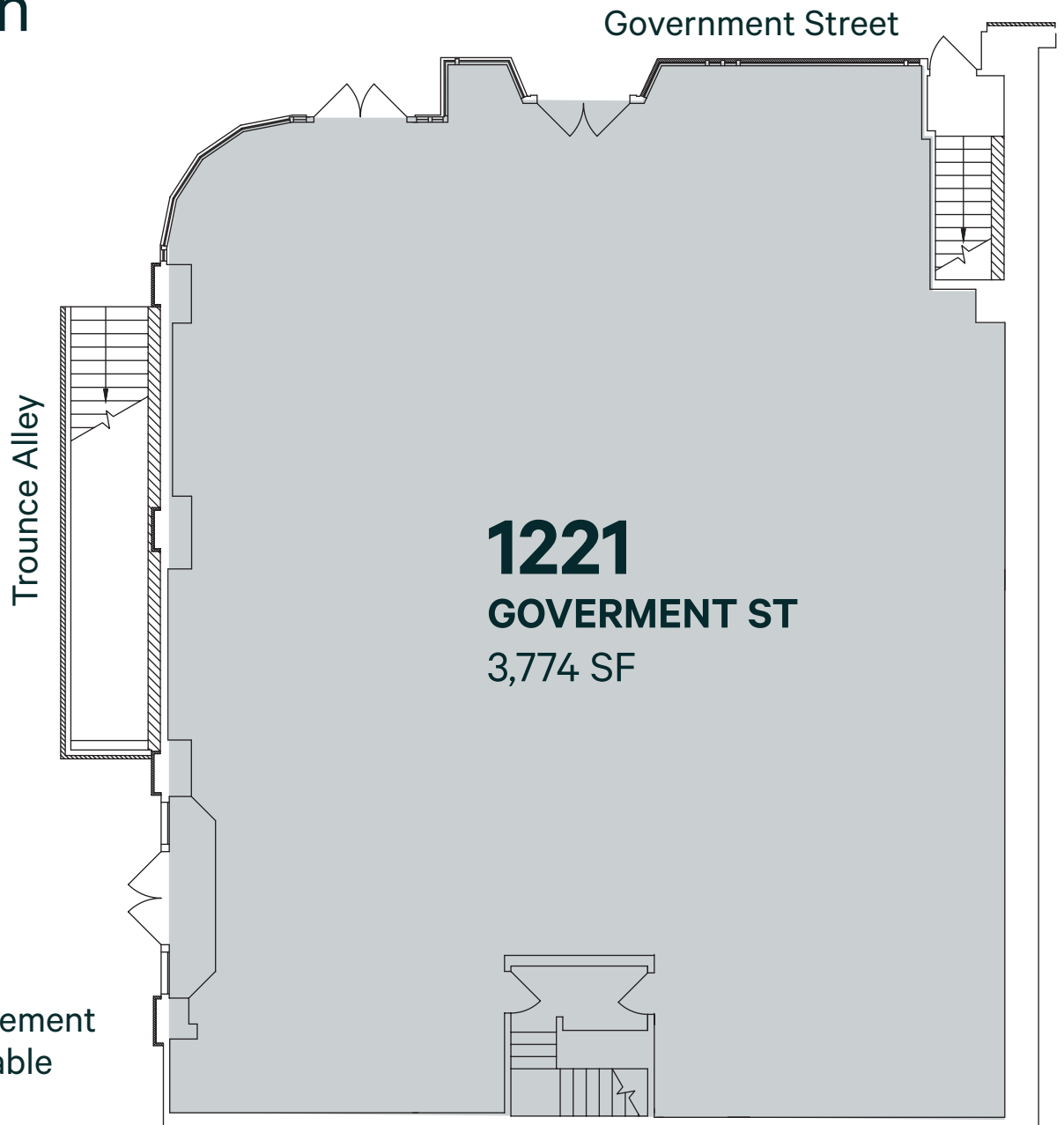

*1,750 SF of Basement Area Also Available

Details

UNIT	SIZE	NET RENT:	
Main Floor	3,774 SF	Main Floor:	\$55.00 PSF
Basement Area*	1,750 SF	Basement Area:	\$15.00 PSF Gross
<hr/>		ADDITIONAL RENT:	
Total	5,524 SF	\$12.80 PSF (2021 Estimate)	
AVAILABLE: Immediately			



- | | | | |
|----------------------|--------------------|--------------------------|---------------------------|
| 1 Lululemon | 6 Arc'teryx | 11 New Balance | 16 Garrick's Head |
| 2 MEC | 7 Starbucks | 12 Earl's | 17 Irish Times Pub |
| 3 David's Tea | 8 Patagonia | 13 The Bay | 18 Running Room |
| 4 Fjallraven | 9 Street | 14 Below The Belt | 19 Eddie Bauer |
| 5 GAP | 10 Roots | 15 Lugaro | 20 Ecco Shoes |

Downtown Victoria is a vibrant urban neighbourhood, a walkable shopping area, and a thriving entertainment district. It hosts not only the world-renowned Inner Harbour, The Fairmont Empress hotel and Legislature Buildings, but also Canada's oldest Chinatown, and a wonderfully charming Old Town district. Downtown Victoria is without a doubt one of the reasons why Victoria is consistently rated as a premier travel destination across the country, and around the globe. It is picturesque, featuring waterfront paths, charming shops and restaurants, stunning heritage buildings and picture-perfect locations.

1221

Government St

Downtown Victoria, BC

CONTACT

CHRIS RUST
 Personal Real Estate Corporation
 Senior Vice President
 Brokerage Services
 250 386 0005
 chris.rust@cbre.com

REID MALTMAN
 Sales Representative
 Brokerage Services
 250 385 1225
 reid.maltman@cbre.com

INVESTMENT PROPERTIES GROUP
 VICTORIA

CBRE LIMITED 1026 FORT STREET | VICTORIA, BC V8V 3K4 | WWW.CBREVICTORIA.COM

This disclaimer shall apply to CBRE Limited, Real Estate Brokerage, and to all other divisions of the Corporation, to include all employees and independent contractors (CBRE). The information set out herein, including, without limitation, any projections, images, opinions, assumptions and estimates obtained from third parties (the "Information") has not been verified by CBRE, and CBRE does not represent, warrant or guarantee the accuracy, correctness and completeness of the Information. CBRE does not accept or assume any responsibility or liability, direct or consequential, for the Information or the recipient's reliance upon the Information. The recipient of the Information should take such steps as the recipient may deem necessary to verify the Information prior to placing any reliance upon the Information. The Information may change and any property described in the Information may be withdrawn from the market at any time without notice or obligation to the recipient from CBRE. CBRE and the CBRE logo are the service marks of CBRE Limited and/or its affiliated or related companies in other countries. All other marks displayed on this document are the property of their respective owners. All Rights Reserved. Mapping Sources: Canadian Mapping Services canadamapping@cbre.com; DMTI Spatial, Environics Analytics, Microsoft Bing, Google Earth.

