

**THE HARO**

VIEW LIFE. LIVE INSPIRED.

5120 Cordova Bay Road | Saanich, BC

**FOR SALE**

# Final Remaining Strata Unit in Cordova Bay's New Landmark Development

**OVER  
95%  
SOLD**



**Building 2**  
Last Unit Remaining

**Building 1**  
Complete  
SOLD OUT

**Building 3**  
Complete  
SOLD OUT





# Building 2

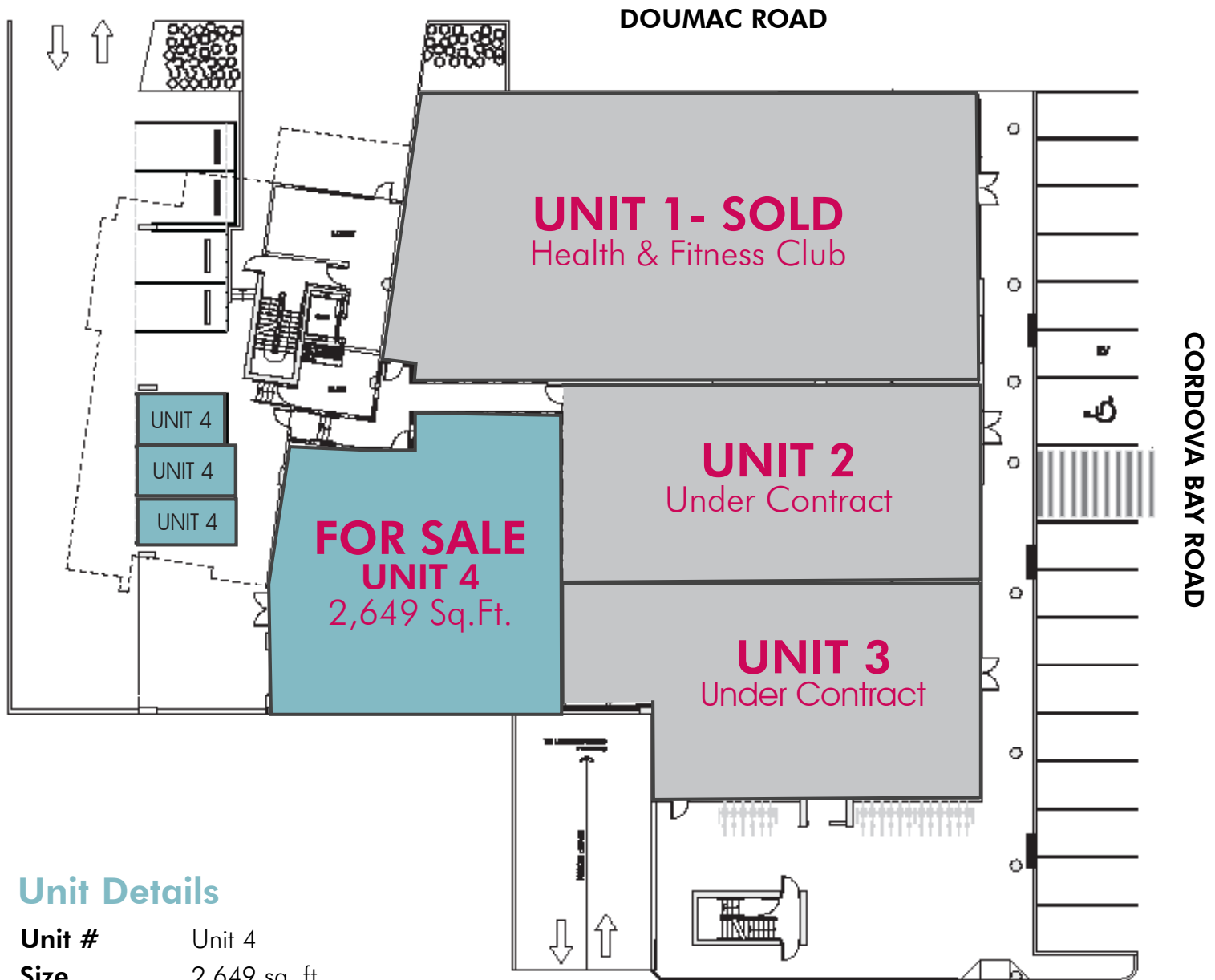

## Unit Details

<b>Unit #</b>	Unit 4
<b>Size</b>	2,649 sq. ft.
<b>Strata Fees</b>	\$7,126/year approx.
<b>Price</b>	<b>\$1,450,000 (plus GST)</b>

## Unit Highlights

- Ground floor retail/office space
- 183 surface level/underground parking stalls onsite
- 3 reserved LCP underground parking stalls, 3 reserved LCP surface parking stalls in front of unit
- 200 amp service
- Occupancy estimated Q2 2022

## Zoning: C-3 Shopping Centre Zone

Uses permitted but not limited to:

- Retail
- Medical services
- Personal services
- Restaurant
- Office
- Daycare

# Your business can benefit from one of the fastest growing communities in Greater Victoria

The population is projected to increase by 32% within a 1km radius of The Haro by 2025



Currently the estimated population is 13,491 within a 3km radius, and 34,560 within a 5km radius.



Approximately **400+ residential units in planning/ approved within 2km of the Haro.**



The **average income is \$142,657** in a 1km radius of the Haro, one of the highest averages in Greater Victoria.



Approximately **8,370 cars** travel by the Haro daily.

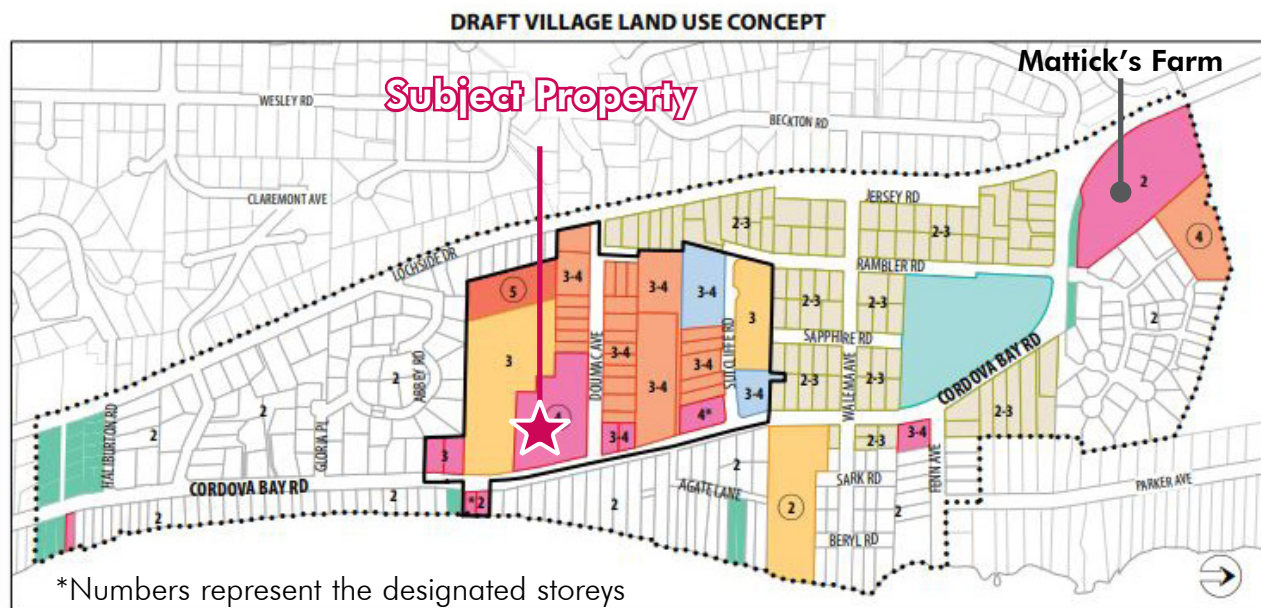

The Cordova Bay LAP is scheduled to be completed this Spring which will guide growth and future development in the local area and specifically the Village Core for the next 20 to 30 years.





## About the Community

The property is located in the seaside neighbourhood of Cordova Bay and within the commercial core of the village centre. This neighbourhood is one of the most sought after areas in Greater Victoria resulting in a dramatic increase in population. A destination for locals and tourists, Mattick's Farm is nearby with a boutique shopping experience with retail shops and restaurants. This friendly community is an outdoor enthusiasts dream, with the Cordova Bay Golf Course and it's executive course The Ridge, hiking, kayaking, and canoeing minutes away. The property is approximately 15 minutes to the Victoria International Airport, 21 minutes to the Swartz Bay Ferry Terminal, and 21 minutes to Downtown Victoria.





**OVER  
95%  
SOLD**



**Last Remaining  
Retail/Office Strata Unit  
Price: \$1,450,000**

[www.theharo.com](http://www.theharo.com)

## Contact Us

**Ross Marshall**  
Personal Real Estate Corporation  
Senior Vice President  
Brokerage Services  
250 386 0004  
[ross.marshall@cbre.com](mailto:ross.marshall@cbre.com)

**Chris Rust**  
Personal Real Estate Corporation  
Senior Vice President  
Brokerage Services  
250 386 0005  
[chris.rust@cbre.com](mailto:chris.rust@cbre.com)

**THE HARO**  
VIEW LIFE. LIVE INSPIRED.

[www.cbrevictoria.com](http://www.cbrevictoria.com) | CBRE Limited  
1026 Fort Street, Victoria, BC V8V 3K4 | 250 386 0000

INVESTMENT PROPERTIES GROUP  
VICTORIA

**CBRE**

This disclaimer shall apply to CBRE Limited, Real Estate Brokerage, and to all other divisions of the Corporation; to include all employees and independent contractors ("CBRE"). The information set out herein, including, without limitation, any projections, images, opinions, assumptions and estimates obtained from third parties (the "Information") has not been verified by CBRE, and CBRE does not represent, warrant or guarantee the accuracy, correctness and completeness of the Information. CBRE does not accept or assume any responsibility or liability, direct or consequential, for the Information or the recipient's reliance upon the Information. The recipient of the Information should take such steps as the recipient may deem necessary to verify the Information prior to placing any reliance upon the Information. The Information may change and any property described in the Information may be withdrawn from the market at any time without notice or obligation to the recipient from CBRE. CBRE and the CBRE logo are the service marks of CBRE Limited and/or its affiliated or related companies in other countries. All other marks displayed on this document are the property of their respective owners. All Rights Reserved. Mapping Sources: Canadian Mapping Services [canadamapping@cbre.com](mailto:canadamapping@cbre.com); DMTI Spatial, Envirionics Analytics, Microsoft Bing, Google Earth.