

**FOR
LEASE**
VICTORIA, BC

1400 QUADRA ST
THE BEACON

UNIT B

UNIT A

DOWNTOWN CORNER RETAIL SPACE

- Prime corner location in Downtown Victoria
- High profile signage opportunities
- Flexible zoning allows for a wide range of uses
- Large floor to ceiling storefront windows
- High ceilings throughout (14')
- Proximity to numerous successful businesses

LEIGHA RUSSELL

Real Estate Associate
Devon Properties

778 405 0885

lrussell@devonproperties.com

ROSS MARSHALL

Personal Real Estate Corporation
Senior Vice President
Brokerage Services

250 386 0004

ross.marshall@cbre.com

Devon
PROPERTIES

CBRE

THE OPPORTUNITY

Lease brand new ground-level commercial space at the corner of Quadra St and Johnson St in Downtown Victoria. The subject spaces benefit from plentiful natural light via large storefront windows and streetside patio potential. With 113 new rental units in the building and over a thousand more residences recently completed or under construction in the area, the retail spaces at 1400 Quadra St are perfectly positioned to receive high pedestrian and vehicle traffic counts year-round.



1400
QUADRA
THE BEACON

FLOORPLANS

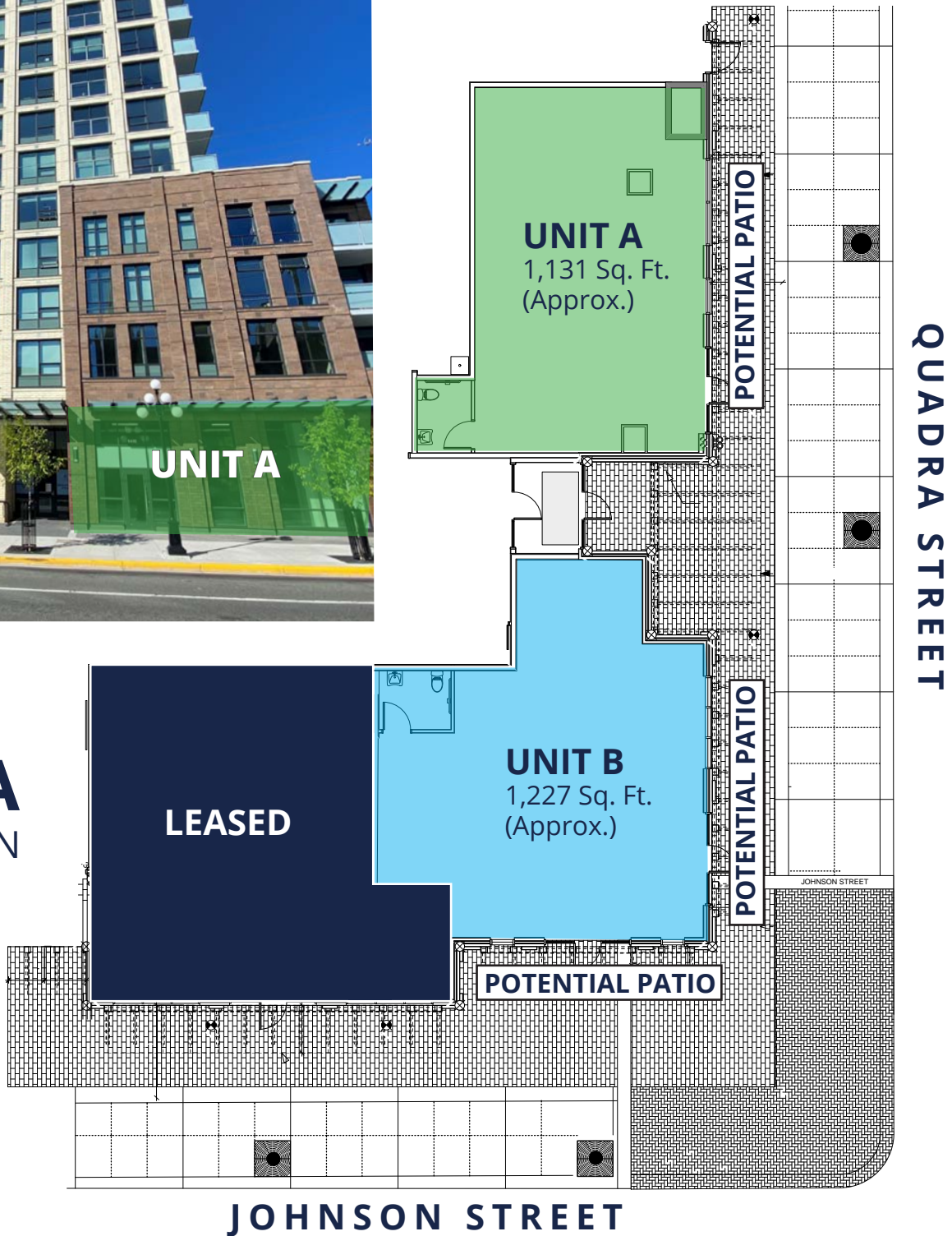

RETAIL UNIT A

SIZE:

1,131 SF

NET RENT:

\$32.00 per SF

ADDITIONAL RENT:

\$16.00 per SF

AVAILABLE:

Immediately

PARKING:

One Underground Reserved Stall

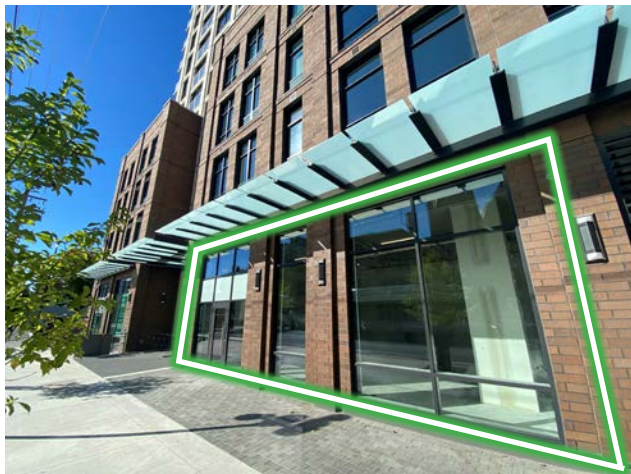

RETAIL UNIT B

SIZE:

1,227 SF

NET RENT:

\$32.00 per SF

ADDITIONAL RENT:

\$16.00 per SF

AVAILABLE:

Immediately

PARKING:

One Underground Reserved Stall



HARRIS GREEN

With Downtown Victoria to the west and neighbourhoods such as Fernwood and Rockland to the east, Harris Green is an ideal location for any business that values a mix of high traffic and close proximity to high residential density. Harris Green is in the midst of a development surge with numerous projects in the pipeline that will continue the trend of increased density, ultimately pushing Victoria's urban core eastward.

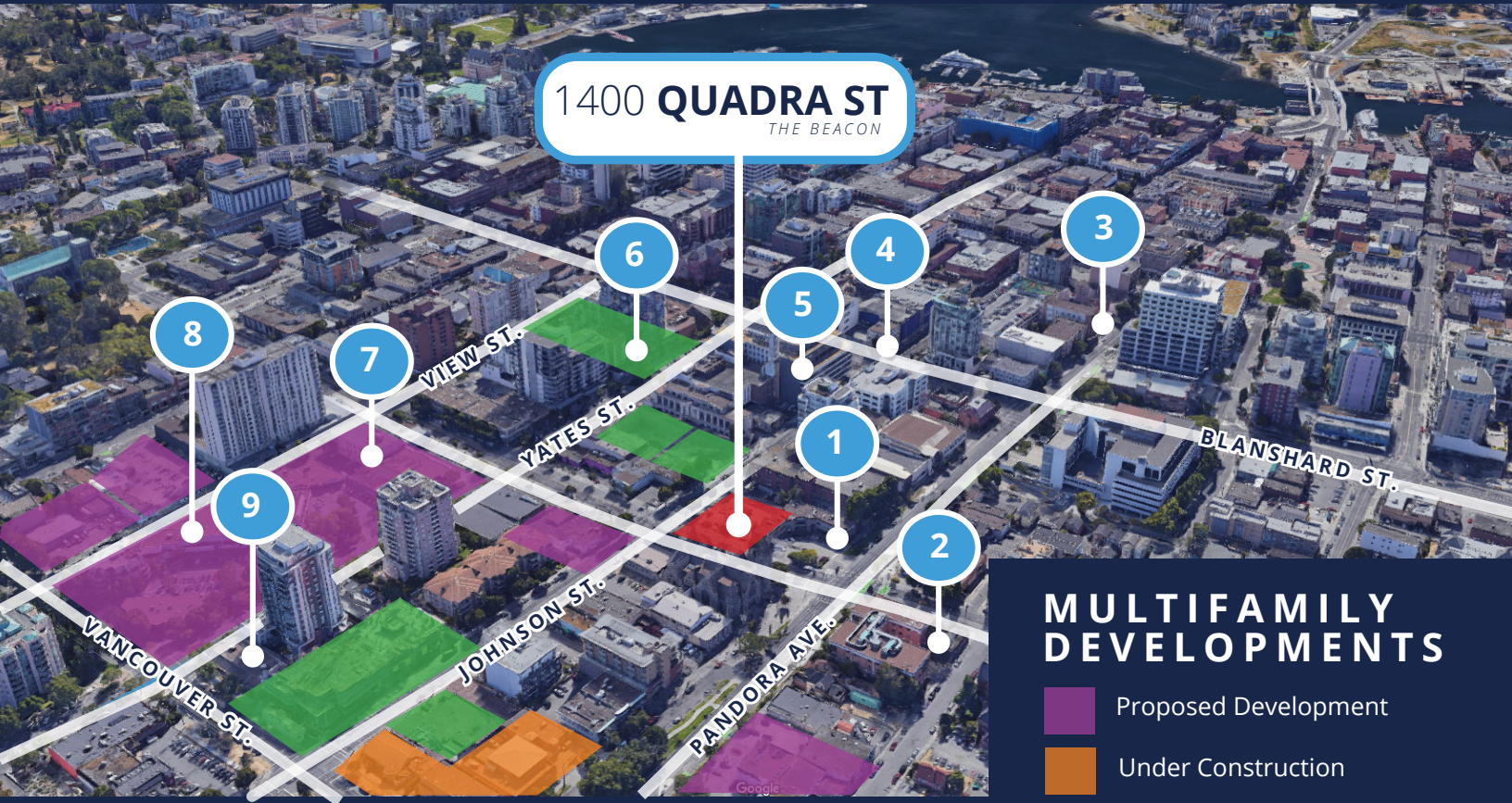

MULTIFAMILY DEVELOPMENTS

- Proposed Development
- Under Construction
- Recently Built

NEIGHBORING BUSINESSES

- | | | |
|---|--|--|
| <p>1 Bold Butchery & Grill
Subway</p> <p>2 Wildfire Bakery</p> <p>3 Tacofino
John's Place
Nubo Japanese Tapas</p> <p>4 Shine Café</p> | <p>5 Suberbaba
Habit Coffee</p> <p>6 Anytime Fitness
Forge Training</p> <p>7 Sakura Sushi</p> | <p>8 The Market on Yates
London Drugs
COBS Bread
Yates Espresso Bar
Bin 4 Burger Lounge</p> <p>9 Atlas Audio Video</p> |
|---|--|--|

LEIGHA RUSSELL

Real Estate Associate
Devon Properties
778 405 0885
lrussell@devonproperties.com

ROSS MARSHALL

Personal Real Estate Corporation
Senior Vice President
CBRE Victoria
250 386 0004
ross.marshall@cbre.com

CBRE LIMITED 1026 FORT STREET | VICTORIA, BC V8V 3K4 | WWW.CBREVICTORIA.COM

Devon
PROPERTIES

CBRE

This disclaimer shall apply to CBRE Limited, Real Estate Brokerage, and to all other divisions of the Corporation, to include all employees and independent contractors ("CBRE"). The information set out herein, including, without limitation, any projections, images, opinions, assumptions and estimates obtained from third parties (the "Information") has not been verified by CBRE, and CBRE does not represent, warrant or guarantee the accuracy, correctness and completeness of the Information. CBRE does not accept or assume any responsibility or liability, direct or consequential, for the Information or the recipient's reliance upon the Information. The recipient of the Information should take such steps as the recipient may deem necessary to verify the Information prior to placing any reliance upon the Information. The Information may change and any property described in the Information may be withdrawn from the market at any time without notice or obligation to the recipient from CBRE. CBRE and the CBRE logo are the service marks of CBRE Limited and/or its affiliated or related companies in other countries. All other marks displayed on this document are the property of their respective owners. All Rights Reserved. Mapping Sources: Canadian Mapping Services canadamapping@cbre.com; DMTI Spatial, EnviroNics Analytics, Microsoft Bing, Google Earth.