

AZZURRO

1,524 - 9,328 SF
Class A office space
in central location

**1952
BLANSHARD
STREET**
Victoria, BC

FOR LEASE



CBRE

OPPORTUNITY

The second floor of the Azzurro is exclusively for the office tenants, with a private lobby entrance on the ground level and dedicated access from the lower secure parking level. The subject suites boast 14' - 16' ceilings throughout, with ample natural light flooding in from large opening windows. The space is delivered in shell condition with the base building Landlord's Work schedule available upon request. TI packages can be provided to qualified tenants, and the Landlord can also turnkey units for tenants with its in-house design and construction team if desired. Brand new washrooms are common to the second floor. Tenants will benefit from highly visible signage opportunities, seen from one of Victoria's busiest commuter thoroughfares.



Lobby Interior

LOCATION

The Azzurro is situated at the northern border of Victoria's downtown core, close to points of interest including the Save on Foods Memorial Arena, Hudson District, Victoria Public Market, and Chinatown. The building is easily accessible off of Blanshard St, one of Victoria's main traffic arteries and the gateway to the Downtown Core.

NET RENT

\$26.00 Per SF (Years 1-5)

\$29.00 Per SF (Years 6-10)

ADDITIONAL RENT

\$11.00 Per SF (2021 EST.)

AVAILABLE

Immediately

DETAILS

Suite 200	2,841 SF
Suite 201	1,524 SF
Suite 203	4,964 SF
Total Leaseable area	9,328 SF

HIGHLIGHTS



Central location just north of downtown core



Large opening windows provide fresh air and natural light throughout



Secure underground parking for vehicles and bikes



Proximity to numerous high-quality amenities



Flexible demising options to suit tenant needs



Exceptional signage opportunity with exposure to 40,000+ vehicles per day



Spacious ground floor lobby entrance and dedicated elevator



1952 Blanshard Street

1952 BLANSHARD STREET

Victoria, BC

FOR LEASE

FOR MORE INFORMATION CONTACT

NATHANIEL SIMPSON
Sales Associate
Brokerage Services
250 386 0001
nathaniel.simpson@cbre.com

JAMES MURRAY
Sales Representative
Brokerage Services
250 385 1225
james.murray@cbre.com

ROSS MARSHALL
PERSONAL REAL ESTATE CORPORATION
Senior Vice President
Brokerage Services
250 386 0004
ross.marshall@cbre.com

This disclaimer shall apply to CBRE Limited, Real Estate Brokerage, and to all other divisions of the Corporation; to include all employees and independent contractors ("CBRE"). The information set out herein, including, without limitation, any projections, images, opinions, assumptions and estimates obtained from third parties (the "Information") has not been verified by CBRE, and CBRE does not represent, warrant or guarantee the accuracy, correctness and completeness of the Information. CBRE does not accept or assume any responsibility or liability, direct or consequential, for the information or the recipient's reliance upon the Information. The recipient of the Information should take such steps as the recipient may deem necessary to verify the information prior to placing any reliance upon the Information. The Information may change and any property described in the Information may be withdrawn from the market at any time without notice or obligation to the recipient from CBRE. CBRE and the CBRE logo are the service marks of CBRE Limited and/or its affiliated or related companies in other countries. All other marks displayed on this document are the property of their respective owners. All Rights Reserved. Mapping Sources: Canadian Mapping Services canadamapping@cbre.com; DMTI Spatial, EnviroNics Analytics, Microsoft Bing, Google Earth.

CBRE

Floor Plan - East

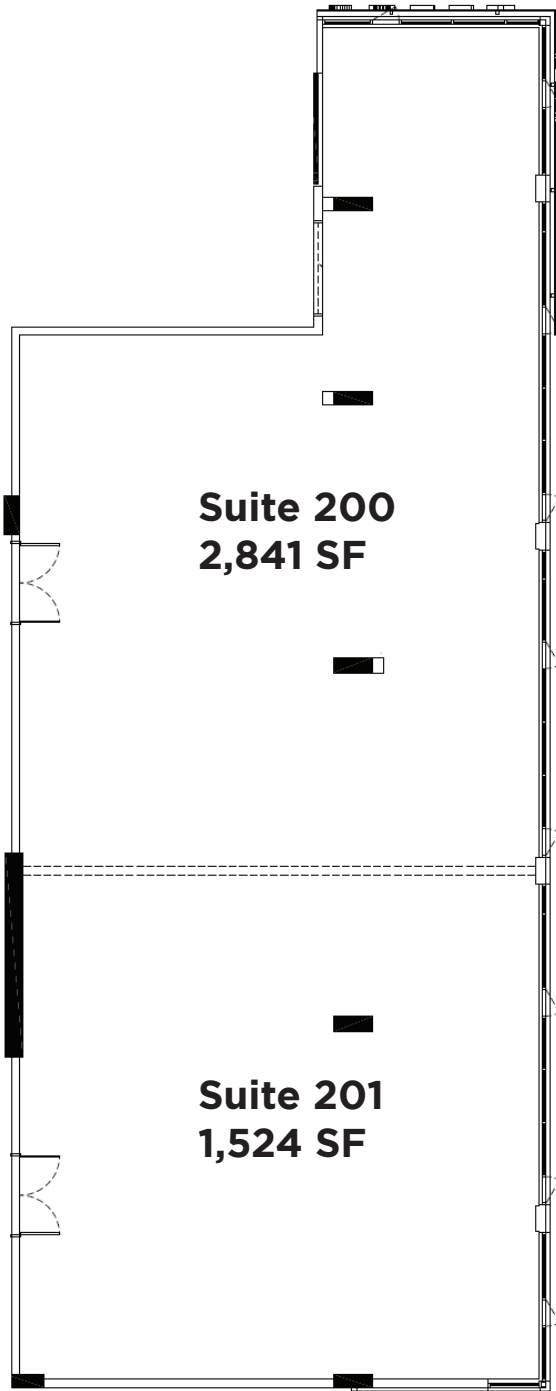

Suite 200
2,841 SF

Suite 201
1,524 SF

1952 BLANSHARD STREET

Victoria, BC

NATHANIEL SIMPSON
Sales Associate
Brokerage Services
250 386 0001
nathaniel.simpson@cbre.com

JAMES MURRAY
Sales Representative
Brokerage Services
250 385 1225
james.murray@cbre.com

ROSS MARSHALL
PERSONAL REAL ESTATE CORPORATION
Senior Vice President
Brokerage Services
250 386 0004
ross.marshall@cbre.com

AZZURRO

CBRE

FOR LEASE

This disclaimer shall apply to CBRE Limited, Real Estate Brokerage, and to all other divisions of the Corporation; to include all employees and independent contractors ("CBRE"). The information set out herein, including, without limitation, any projections, images, opinions, assumptions and estimates obtained from third parties (the "Information") has not been verified by CBRE, and CBRE does not represent, warrant or guarantee the accuracy, correctness and completeness of the Information. CBRE does not accept or assume any responsibility or liability, direct or consequential, for the Information or the recipient's reliance upon the Information. The recipient of the Information should take such steps as the recipient may deem necessary to verify the Information prior to placing any reliance upon the Information. The Information may change and any property described in the Information may be withdrawn from the market at any time without notice or obligation to the recipient from CBRE. CBRE and the CBRE logo are the service marks of CBRE Limited and/or its affiliated or related companies in other countries. All other marks displayed on this document are the property of their respective owners. All Rights Reserved. Mapping Sources: Canadian Mapping Services canadamapping@cbre.com; DMTI Spatial, Environics Analytics, Microsoft Bing, Google Earth.

Floor Plan - West

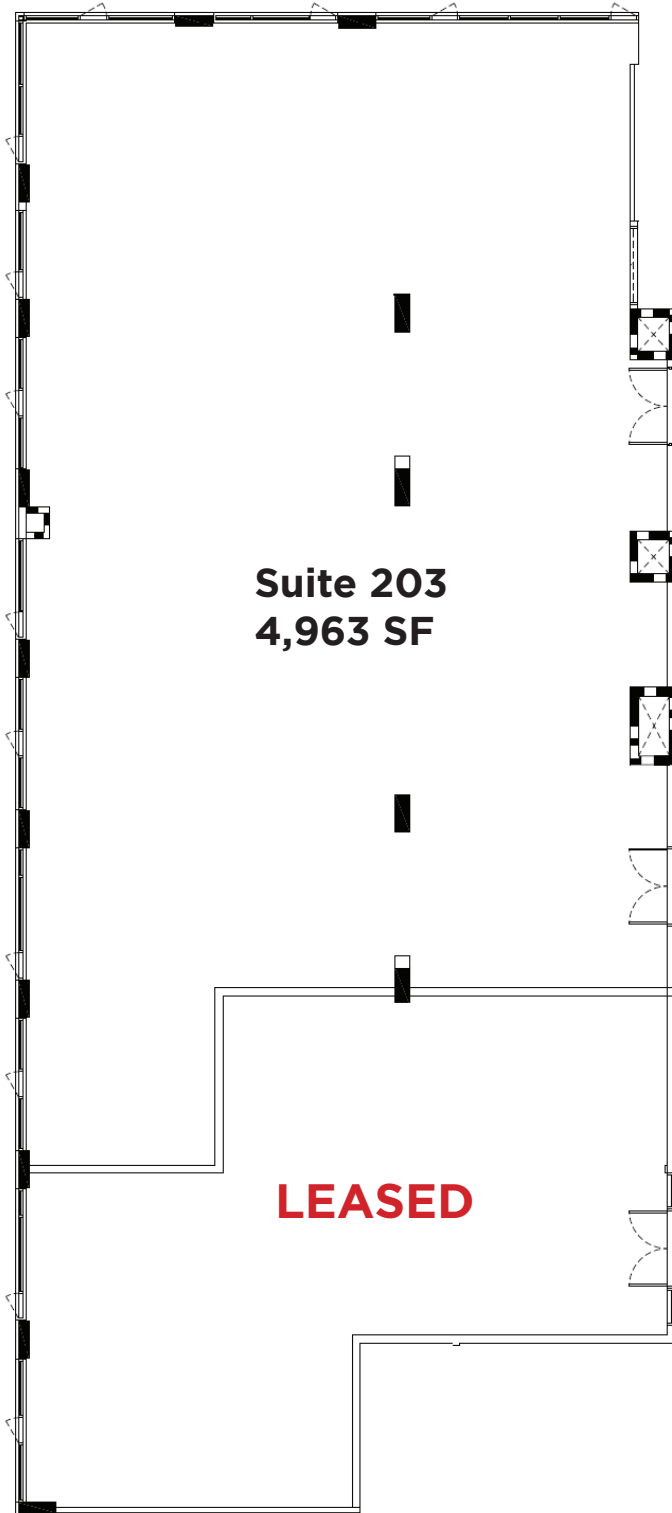

FOR LEASE

1952 BLANSHARD STREET Victoria, BC

NATHANIEL SIMPSON
Sales Associate
Brokerage Services
250 386 0001
nathaniel.simpson@cbre.com

JAMES MURRAY
Sales Representative
Brokerage Services
250 385 1225
james.murray@cbre.com

ROSS MARSHALL
PERSONAL REAL ESTATE CORPORATION
Senior Vice President
Brokerage Services
250 386 0004
ross.marshall@cbre.com

AZZURRO

CBRE

This disclaimer shall apply to CBRE Limited, Real Estate Brokerage, and to all other divisions of the Corporation; to include all employees and independent contractors ("CBRE"). The information set out herein, including, without limitation, any projections, images, opinions, assumptions and estimates obtained from third parties (the "information") has not been verified by CBRE, and CBRE does not represent, warrant or guarantee the accuracy, correctness and completeness of the information. CBRE does not accept or assume any responsibility or liability, direct or consequential, for the information or the recipient's reliance upon the information. The recipient of the information should take such steps as the recipient may deem necessary to verify the information prior to placing any reliance upon the information. The information may change and any property described in the information may be withdrawn from the market at any time without notice or obligation to the recipient from CBRE. CBRE and the CBRE logo are the service marks of CBRE Limited and/or its affiliated or related companies in other countries. All other marks displayed on this document are the property of their respective owners. All Rights Reserved. Mapping Sources: Canadian Mapping Services canadamapping@cbre.com; DMTI Spatial, Envisionics Analytics, Microsoft Bing, Google Earth.