

AVAILABLE NOW



**FOR LEASE**

# **BROUGHTON SQUARE 617 BROUGHTON ST**

Victoria, BC

**RETAIL / OFFICE SPACE IN DOWNTOWN CORE**

## **HIGHLIGHTS**

- \ STEPS FROM THE INNER HARBOUR
- \ CENTRAL DOWNTOWN LOCATION
- \ HIGH FOOT & VEHICLE TRAFFIC YEAR-ROUND
- \ PROMINENT SIGNAGE OPPORTUNITIES
- \ AMPLE PARKING IN BUILDING PARKADE
- \ LARGE STOREFRONT WINDOWS
- \ PROXIMITY TO NUMEROUS LOCAL AND TOURIST SHOPPING DESTINATIONS

## **CONTACT**

**JAMES MURRAY**

Sales Representative  
Brokerage Services

250 385 1225

[james.murray@cbre.com](mailto:james.murray@cbre.com)

**NATHANIEL SIMPSON**

Sales Associate  
Brokerage Services

250 386 0001

[nathaniel.simpson@cbre.com](mailto:nathaniel.simpson@cbre.com)

**CBRE**



# FOR LEASE BROUGHTON SQUARE

**617 BROUGHTON ST**  
VICTORIA, BC

## THE OPPORTUNITY

Lease retail space at the heart of Downtown Victoria, situated between the Central Business District and Old Town. The subject retail unit benefits from high traffic counts year-round for both vehicles and pedestrians, proximity to a variety of thriving business, and a central location within Victoria's Downtown Core.

## DETAILS

**SIZE:** **617 Broughton St:** 979 SF  
**621 Broughton St:** 1,459 SF  
**625 Broughton St:** 891 SF  
**622 Courtney St:** 1,231 SF

**NET RENT:** Contact Listing Agent  
**ADDITIONAL RENT:** \$15.75 PSF (2021 est.)  
**AVAILABILITY:** Immediate

# SITE PLAN

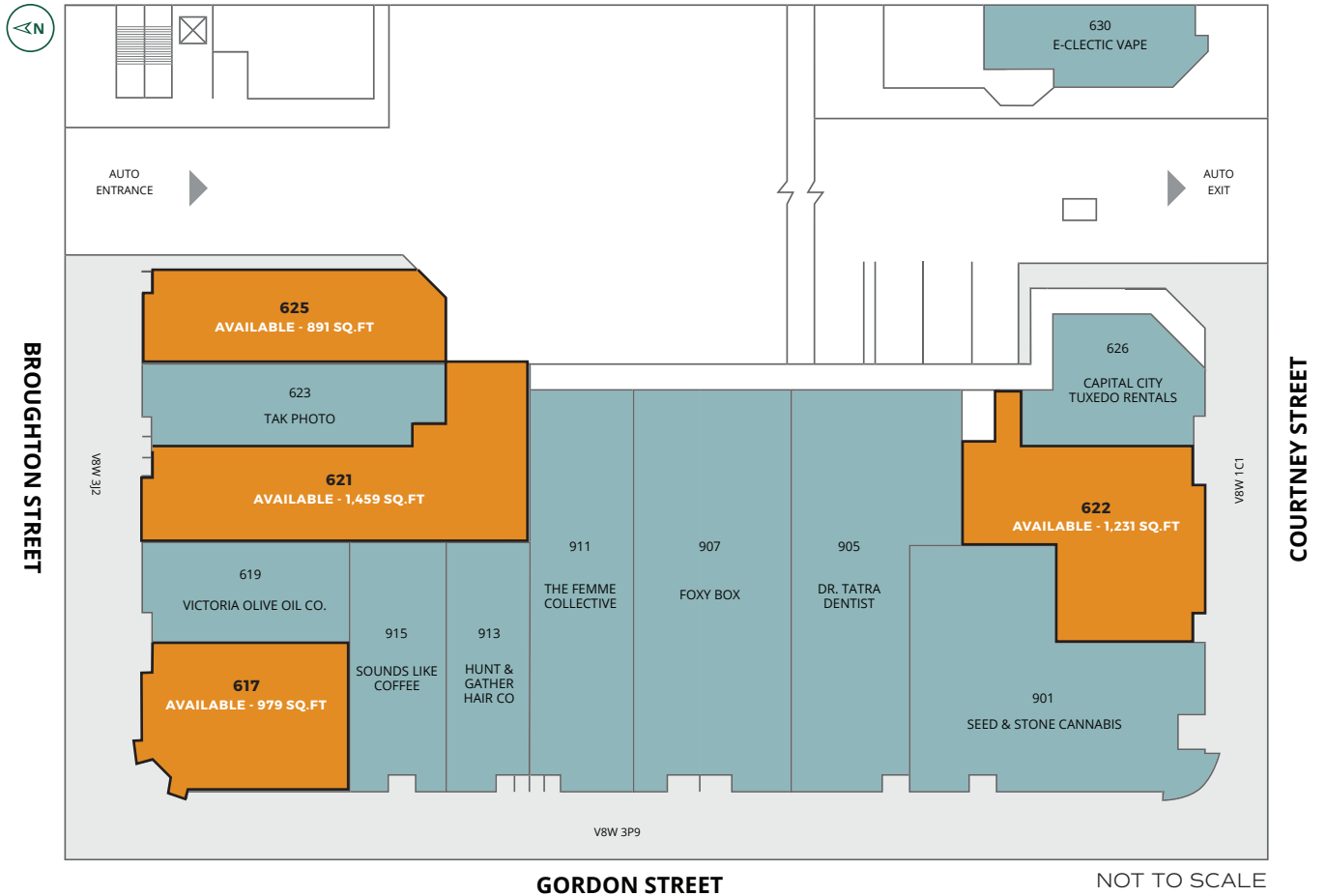

GORDON STREET

NOT TO SCALE



# FOR LEASE BROUGHTON SQUARE

RETAIL / OFFICE SPACE IN  
DOWNTOWN CORE

## 617 BROUGHTON ST

VICTORIA, BC

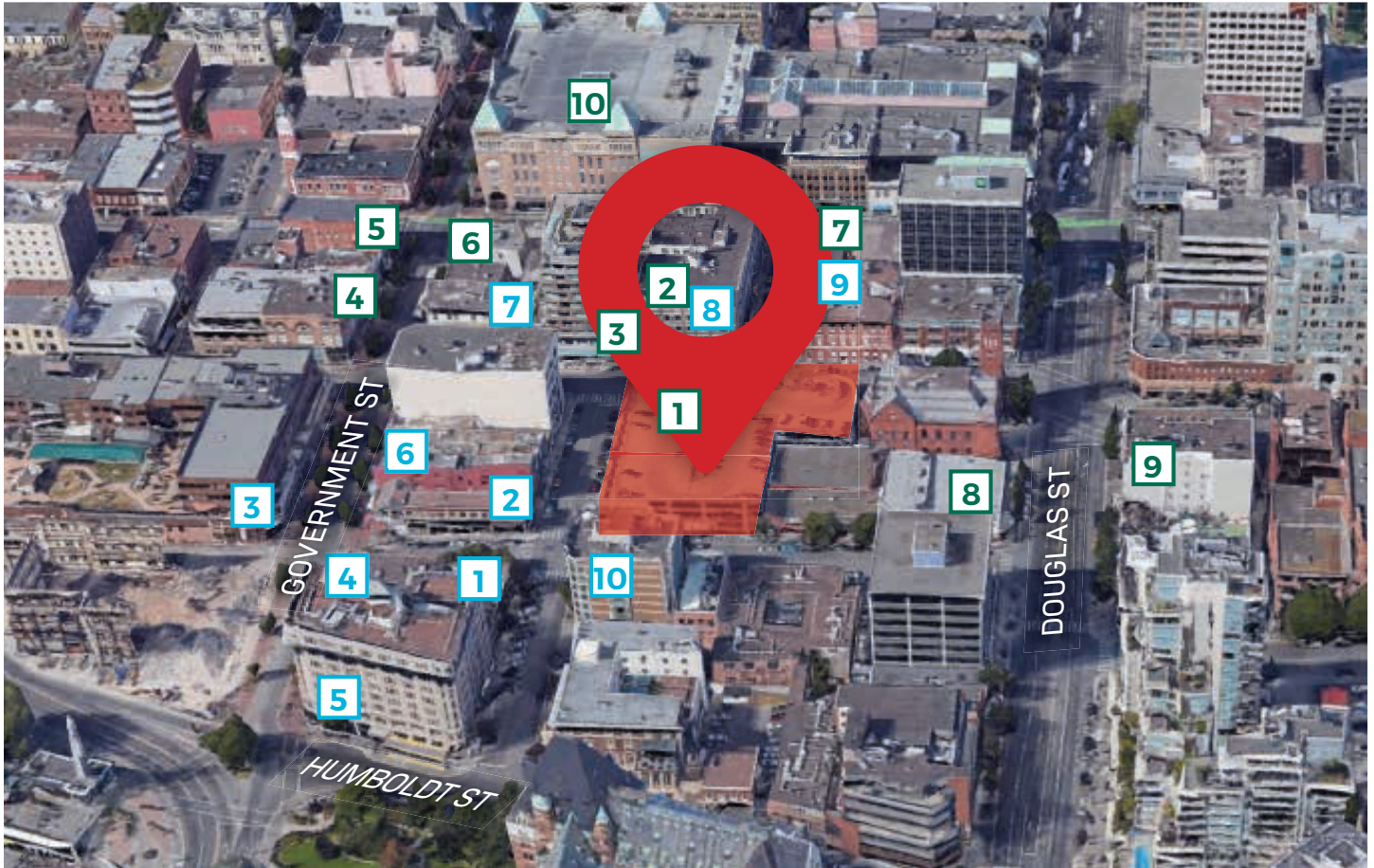

### RETAIL

- 1 Seed and stone Cannabis
- 2 D.G. Brenner & Co. Menswear
- 3 Bagheera Boutique
- 4 Black Goat Cashmere
- 5 Lush
- 6 Birks
- 7 Trek Wear
- 8 Rexall
- 9 The Strath Liquor Store
- 10 The Bay Centre

### FOOD/BEVERAGE

- 1 10 Acres Bistro
- 2 Sandwich Corner Café
- 3 Frankie's Modern Diner
- 4 Milano Coffee
- 5 Tractor Foods
- 6 Rogers Chocolates
- 7 Ebizo Sushi
- 8 Macchiato Café
- 9 Pagliacci's
- 10 The Courtney Room



\*Source: Walkscore.com

# CBRE

CBRE Limited  
1026 Fort Street | Victoria, BC V8V 3K4 | [www.cbrevictoria.com](http://www.cbrevictoria.com)

This disclaimer shall apply to CBRE Limited, Real Estate Brokerage, and to all other divisions of the Corporation; to include all employees and independent contractors ("CBRE"). The information set out herein, including, without limitation, any projections, images, opinions, assumptions and estimates obtained from third parties (the "Information") has not been verified by CBRE, and CBRE does not represent, warrant or guarantee the accuracy, correctness and completeness of the Information. CBRE does not accept or assume any responsibility or liability, direct or consequential, for the information or the recipient's reliance upon the information. The recipient of the information should take such steps as the recipient may deem necessary to verify the information prior to placing any reliance upon the information. The information may change and any property described in the information may be withdrawn from the market at any time without notice or obligation to the recipient from CBRE. CBRE and the CBRE logo are the service marks of CBRE Limited and/or its affiliated or related companies in other countries. All other marks displayed on this document are the property of their respective owners. All Rights Reserved. Mapping Sources: Canadian Mapping Services [canadamapping@cbre.com](mailto:canadamapping@cbre.com); DMTI Spatial, Envirionics Analytics, Microsoft Bing, Google Earth.

## CONTACT

**JAMES MURRAY**  
Sales Representative  
Brokerage Services  
250 385 1225  
[james.murray@cbre.com](mailto:james.murray@cbre.com)

**NATHANIEL SIMPSON**  
Sales Associate  
Brokerage Services  
250 386 0001  
[nathaniel.simpson@cbre.com](mailto:nathaniel.simpson@cbre.com)