

# FOR LEASE

---

785 Lampson Street | Esquimalt, BC



## 5,333 SF Industrial Space

- ▶ One 10' high dock door
- ▶ One 14' high grade door
- ▶ 25' ceiling height
- ▶ Zoning allows for a wide range of light industrial and service commercial uses
- ▶ Located in Esquimalt and minutes from Downtown Victoria

# The Opportunity

CBRE is pleased to present the opportunity to lease 5,333 Sq Ft. warehouse and office space in the Esquimalt Industrial Park. The warehouse is comprised of one dock and one grade level loading doors, approximately 25' ceilings, and gas overhead heat.

# The Details

<b>Civic Address</b>	785 Lampson Street, Esquimalt, BC
<b>Leaseable Area</b>	5,333 Sq. Ft.
<b>Heat</b>	Overhead gas in warehouse
<b>Loading Doors</b>	1 dock and 1 grade level loading door Grade: 10'W x 14'H Dock: 10'W x 10'H
<b>Rental Rate</b>	\$16.50 per Sq. Ft.
<b>Operating Costs &amp; Taxes</b>	\$6.00 per Sq. Ft. (Est. 2021)
<b>Availability</b>	February 1, 2021



# The Zoning

## I-1 Light Industrial

Uses permitted but not limited to:

- Automobile, servicing and body shop
- Cold storage plant
- Commercial laundry or drycleaning plant
- Fitness centre
- Food preparation
- Light manufacturing and processing
- Trade contractor establishment
- Warehousing and storage
- Wholesaling and wholesale distribution, including accessory retail

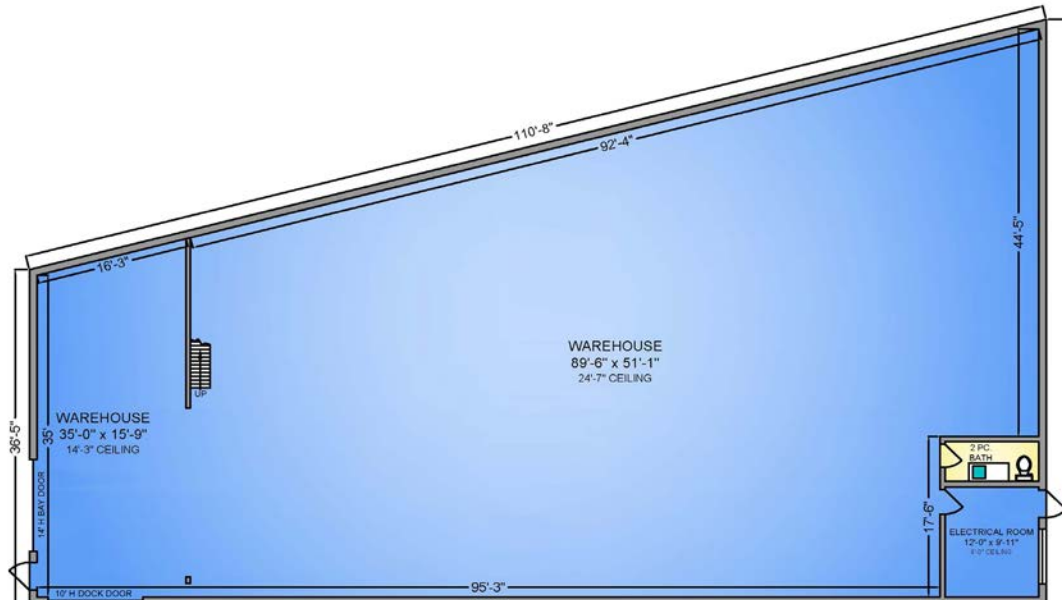

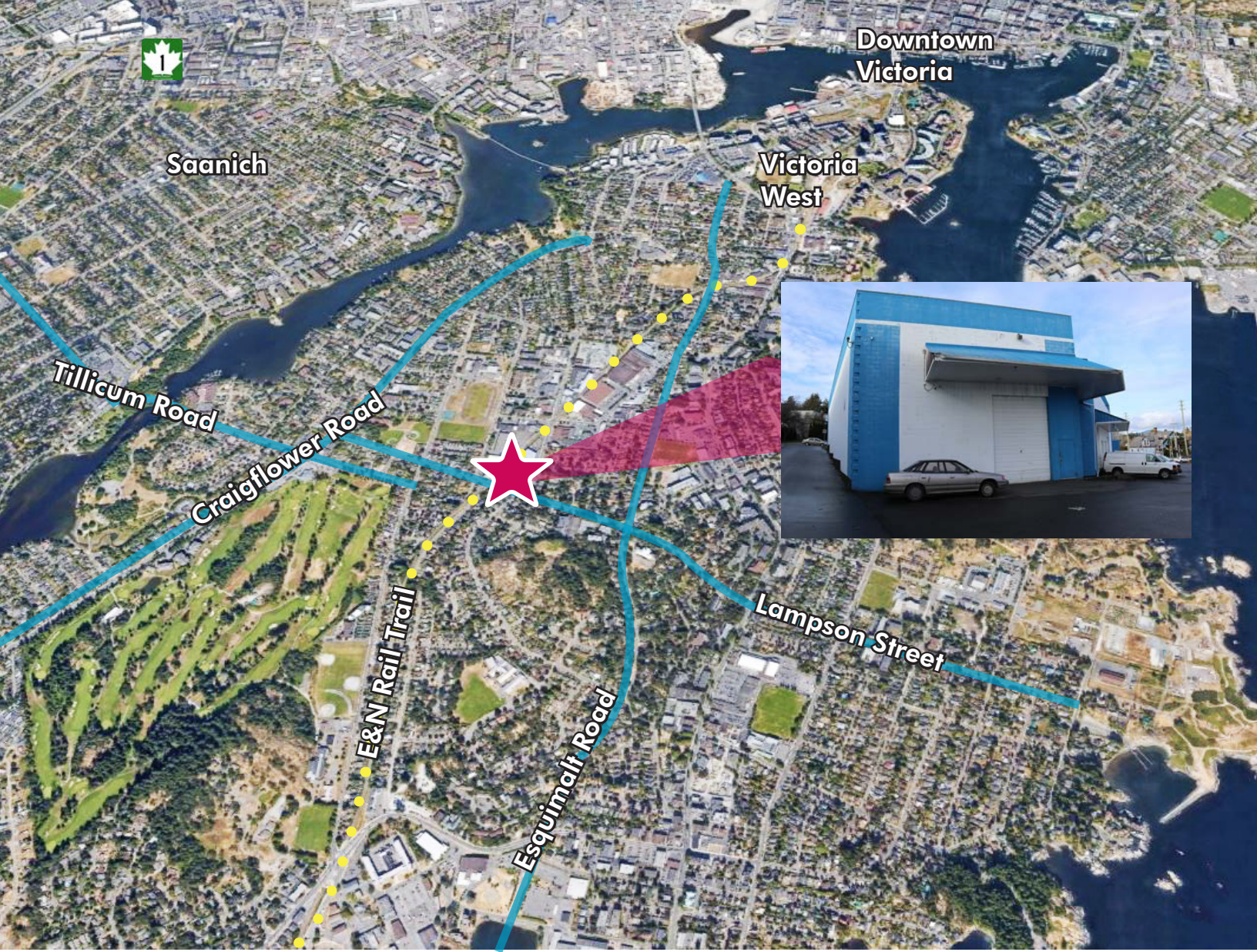

Downtown  
Victoria

Saanich

Victoria  
West

Tillicum Road

Craigflower Road

E&N Rail Trail

Esquimalt Road

Lampson Street

## The Opportunity

The subject property is situated in a highly desirable location in the Esquimalt Industrial District. Just 5 minutes from Downtown Victoria, it has easy access to major transportation routes providing excellent access to surrounding municipality.

## CONTACT US

**Chris Rust**

Personal Real Estate Corporation  
Senior Vice President  
Brokerage Services  
250 386 0005  
chris.rust@cbre.com

**Ross Marshall**

Personal Real Estate Corporation  
Senior Vice President  
Brokerage Services  
250 386 0004  
ross.marshall@cbre.com

www.cbrevictoria.com | CBRE Limited  
1026 Fort Street, Victoria, BC V8V 3K4 | 250 386 0000

This disclaimer shall apply to CBRE Limited, Real Estate Brokerage, and to all other divisions of the Corporation, to include all employees and independent contractors ("CBRE"). The information set out herein, including, without limitation, any projections, images, opinions, assumptions and estimates obtained from third parties (the "Information") has not been verified by CBRE, and CBRE does not represent, warrant or guarantee the accuracy, completeness and timeliness of the Information. CBRE does not accept or assume any responsibility or liability, direct or consequential, for the Information or the recipient's reliance upon the Information. The recipient of the Information should take such steps as the recipient may deem necessary to verify the Information prior to placing any reliance upon the Information. The Information may change and any property described in the Information may be withdrawn from the market at any time without notice or obligation to the recipient from CBRE. CBRE and the CBRE logo are the service marks of CBRE Limited and/or its affiliated or related companies in other countries. All other marks displayed on this document are the property of their respective owners. All Rights Reserved. Mapping Sources: Canadian Mapping Services canadamapping@cbre.com; DMTI Spatial, Esri/arcgis.com, Microsoft Bing, Google Earth.

