



FOR LEASE

**1564 FORT
STREET**

Victoria, BC

NEIGHBOURHOOD RETAIL/OFFICE SPACE AT STADACONA CENTRE

- ✓ CENTRAL LOCATION NEAR DOWNTOWN CORE
- ✓ ON-SITE PARKING FOR CUSTOMERS/CLIENTS
- ✓ AMPLE NATURAL LIGHT THROUGHOUT
- ✓ HIGH-PROFILE SIGNAGE ON FORT STREET

CBRE

ROSS MARSHALL

PERSONAL REAL ESTATE CORPORATION
Senior Vice President
Brokerage Services
250 386 0004
ross.marshall@cbre.com

NATHANIEL SIMPSON

Sales Associate
Brokerage Services
250 386 0001
nathaniel.simpson@cbre.com

JAMES MURRAY

Sales Representative
Brokerage Services
250 385 1225
james.murray@cbre.com

FOR LEASE

1564 FORT STREET

Victoria, BC



DETAILS

AVAILABLE SPACE:	939 SF
NET RENT:	\$20.00 PSF
ADDITIONAL RENT:	\$9.63 PSF (est.)
AVAILABILITY:	Immediately

THE OPPORTUNITY

This is an opportunity to lease boutique commercial space at Stadacona Centre. The subject space is well suited to a variety of retail/office uses and benefits from its location along the high-traffic Fort Street commuter corridor as well as its proximity to the downtown core and some of Victoria's most affluent neighbourhoods.

NEIGHBOURHOOD RETAIL/OFFICE SPACE AT STADACONA CENTRE

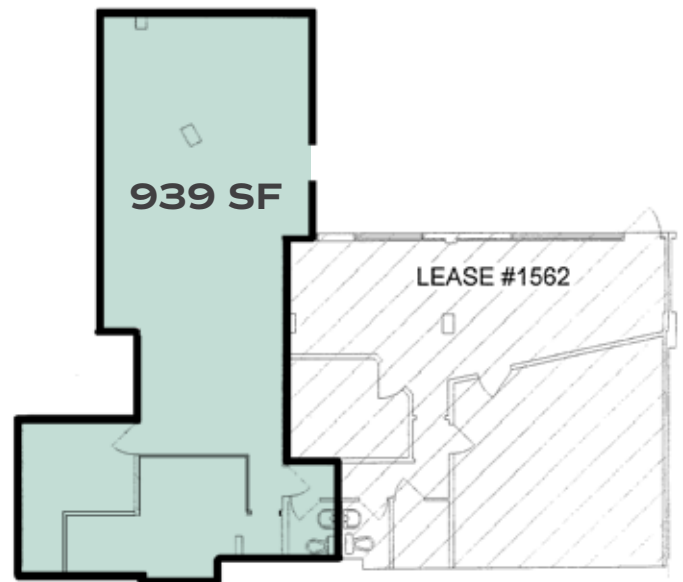

CONTACT

ROSS MARSHALL

PERSONAL REAL ESTATE CORPORATION
Senior Vice President
Brokerage Services
250 386 0004
ross.marshall@cbre.com

NATHANIEL SIMPSON

Sales Associate
Brokerage Services
250 386 0001
nathaniel.simpson@cbre.com

JAMES MURRAY

Sales Representative
Brokerage Services
250 385 1225
james.murray@cbre.com

CBRE Limited | 1026 Fort Street | Victoria, BC V8V 3K4 | www.cbrevictoria.com

This disclaimer shall apply to CBRE Limited, Real Estate Brokerage, and to all other divisions of the Corporation; to include all employees and independent contractors ("CBRE"). The information set out herein, including, without limitation, any projections, images, opinions, assumptions and estimates obtained from third parties (the "Information") has not been verified by CBRE, and CBRE does not represent, warrant or guarantee the accuracy, correctness and completeness of the information. CBRE does not accept or assume any responsibility or liability, direct or consequential, for the information or the recipient's reliance upon the information. The recipient of the information should take such steps as the recipient may deem necessary to verify the information prior to placing any reliance upon the information. The information may change and any property described in the information may be withdrawn from the market at any time without notice or obligation to the recipient from CBRE. CBRE and the CBRE logo are the service marks of CBRE Limited and/or its affiliated or related companies in other countries. All other marks displayed on this document are the property of their respective owners. All Rights Reserved. Mapping Sources: Canadian Mapping Services canadamapping@cbre.com; DMTI Spatial, Environics Analytics, Microsoft Bing, Google Earth.

CBRE

FOR LEASE

1564 FORT STREET

Victoria, BC

AMENITIES NEARBY

- | | | | | | |
|---|-----------------------------------|----|------------------------|----|---------------------------------|
| 1 | Sunshine Cafe | 6 | Absolute Therapy | 11 | Pigeohole Home Store |
| 2 | The Tartan Toque | 7 | Shoppers Drug Mart | 12 | SingIT Studio |
| 3 | Subway | 8 | Vessel Liquor | 13 | Nightingale |
| 4 | Pocket Clothing | 9 | SoundHounds | 14 | Victoria Rose Cosmetic |
| 5 | Active Health and Wellness Clinic | 10 | Stadacona Tennis Court | 15 | Urban Lotus Acupuncture & Herbs |



CONTACT

ROSS MARSHALL

PERSONAL REAL ESTATE CORPORATION
Senior Vice President
Brokerage Services
250 386 0004
ross.marshall@cbre.com

NATHANIEL SIMPSON

Sales Associate
Brokerage Services
250 386 0001
nathaniel.simpson@cbre.com

JAMES MURRAY

Sales Representative
Brokerage Services
250 385 1225
james.murray@cbre.com

CBRE Limited | 1026 Fort Street | Victoria, BC V8V 3K4 | www.cbrevictoria.com

This disclaimer shall apply to CBRE Limited, Real Estate Brokerage, and to all other divisions of the Corporation; to include all employees and independent contractors ("CBRE"). The information set out herein, including, without limitation, any projections, images, opinions, assumptions and estimates obtained from third parties (the "Information") has not been verified by CBRE, and CBRE does not represent, warrant or guarantee the accuracy, correctness and completeness of the information. CBRE does not accept or assume any responsibility or liability, direct or consequential, for the information or the recipient's reliance upon the information. The recipient of the information should take such steps as the recipient may deem necessary to verify the information prior to placing any reliance upon the information. The information may change and any property described in the information may be withdrawn from the market at any time without notice or obligation to the recipient from CBRE. CBRE and the CBRE logo are the service marks of CBRE Limited and/or its affiliated or related companies in other countries. All other marks displayed on this document are the property of their respective owners. All Rights Reserved. Mapping Sources: Canadian Mapping Services canadamapping@cbre.com; DMTI Spatial, Enironics Analytics, Microsoft Bing, Google Earth.

CBRE