

# FOR SALE

## 2 Approved Subdivisions in a Master Planned Community



### 2600 Nickson Way | Sooke, BC

- ▶ Preliminary lot approval
- ▶ 23 fee simple lots & 21 bare land strata lots
- ▶ Purchase can be phased
- ▶ Lot sizes range from 4,761 - 12,629 Sq. Ft.
- ▶ Sewer fees paid
- ▶ All services to the lot (hydro, water & sewer)
- ▶ Panoramic ocean and mountain views
- ▶ Larger lot sizes than the competition
- ▶ Best planned community/care awards (2010)
- ▶ 5.8 km trail system and 111 acres parkland

# The Opportunity

The Investment Properties Group is pleased to present the opportunity to acquire 23 fee simple lots and/or 21 bare land strata lots located in the growing community of Sunriver Estates. The site is 8.82 acres in size and the project can be developed in phases. The property has ocean and mountain views with lots ranging from 4,761 - 12,629 Sq. Ft. This residential development includes a 5.8 km trail system along two rivers with 111 acres of parkland and walking distance to amenities such as the Seaparc Leisure Complex.

## The Details

**Civic Address**

2600 Nickson Way, Sooke, BC

**PID**

004-621-131

**Legal Address**

Lot 1 Plan VIP13674 Section 29 Land District 55 Except Plan VIP75447 & EXC PL VIP76938, VIP80698, VIP83653, VIP85291, VIP87411, VIP87938, EPP30466, EPP45275, EPP53708 & EPP73358 & EPP80307

**Land Size**

8.82 Acres/ 384,199 Sq. Ft.

**PRICE**

**\$4,500,000**

**PRICE/ LOT**

**\$102,273**

## Part A:

**# of Lots**

23 Fee Simple Lots

**Lot Sizes**

6,462 - 12,629 Sq. Ft.

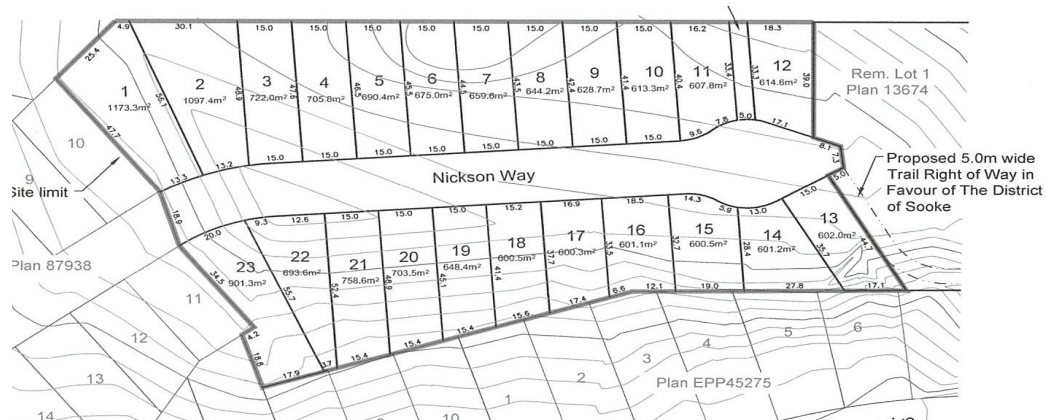

## Part B:

**# of Lots**

21 Bare Land Strata Lots

**Lot Sizes**

4,761 - 9,036 Sq. Ft.

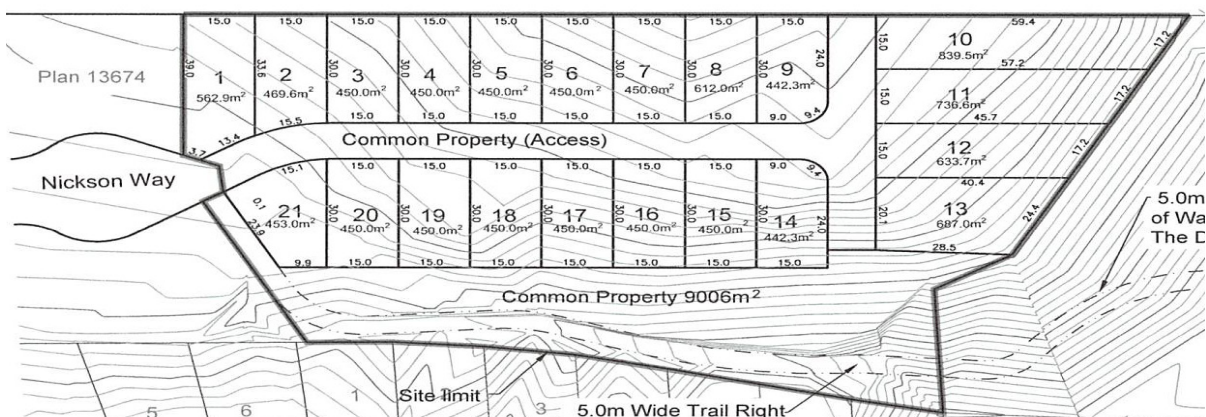





**CBRE**





## About the **Neighbourhood**

- ▶ 35 minutes from Downtown Victoria
- ▶ 2 minutes from downtown Sooke
- ▶ Midway between Port Renfrew and Victoria
- ▶ Just off highway 14/ Sooke Road
- ▶ 5.8 km trail system and 111 acres parkland
- ▶ Near the Galloping Goose Regional Trail
- ▶ Hiking, golfing, scuba diving, world class fishing, surfing, biking and kayaking activities in the immediate area
- ▶ Seaparc Leisure Complex within walking distance offering a variety of recreational activities for all ages



## CONTACT US

### Chris Rust

Personal Real Estate Corporation  
Senior Vice President  
Brokerage Services  
250 386 0005  
chris.rust@cbre.com

### Ross Marshall

Personal Real Estate Corporation  
Senior Vice President  
Brokerage Services  
250 386 0004  
ross.marshall@cbre.com

[www.cbrevictoria.com](http://www.cbrevictoria.com) | CBRE Limited  
1026 Fort Street, Victoria, BC V8V 3K4 | 250 386 0000

INVESTMENT PROPERTIES GROUP  
VICTORIA

**CBRE**

This disclaimer shall apply to CBRE Limited, Real Estate Brokerage, and to all other divisions of the Corporation, to include all employees and independent contractors ("CBRE"). The information set out herein, including, without limitation, any projections, images, opinions, assumptions and estimates obtained from third parties (the "Information") has not been verified by CBRE, and CBRE does not represent, warrant or guarantee the accuracy, completeness and/or timeliness of the Information. CBRE does not accept or assume any responsibility or liability, direct or consequential, for the information or the recipient's reliance upon the Information. The recipient of the Information should take such steps as the recipient may deem necessary to verify the information prior to placing any reliance upon the Information. The information may change and any property described in the Information may be withdrawn from the market at any time without notice or obligation to the recipient from CBRE. CBRE and the CBRE logo are the service marks of CBRE Limited and/or its affiliated or related companies in other countries. All other marks displayed on this document are the property of their respective owners. All Rights Reserved. Mapping Sources: Canadian Mapping Services canadamapping@cbre.com, DMTI Spatial, Envision Analytics, Microsoft Bing, Google Earth.