

# CBRE

Unit 101 & 103

## 3 Fan Tan Alley

VICTORIA, BC



### Boutique Retail Space in Heritage Building

CBRE LIMITED | 1026 Fort Street | Victoria, BC V8V 3K4 | [www.cbrevictoria.com](http://www.cbrevictoria.com)

This disclaimer shall apply to CBRE Limited, Real Estate Brokerage, and to all other divisions of the Corporation; to include all employees and independent contractors ("CBRE"). The information set out herein, including, without limitation, any projections, images, opinions, assumptions and estimates obtained from third parties (the "Information") has not been verified by CBRE, and CBRE does not represent, warrant or guarantee the accuracy, correctness and completeness of the Information. CBRE does not accept or assume any responsibility or liability, direct or consequential, for the Information or the recipient's reliance upon the Information. The recipient of the Information should take such steps as the recipient may deem necessary to verify the Information prior to placing any reliance upon the Information. The Information may change and any property described in the Information may be withdrawn from the market at any time without notice or obligation to the recipient from CBRE. CBRE and the CBRE logo are the service marks of CBRE Limited and/or its affiliated or related companies in other countries. All other marks displayed on this document are the property of their respective owners. All Rights Reserved. Mapping Sources: Canadian Mapping Services [canadamapping@cbre.com](mailto:canadamapping@cbre.com); DMTI Spatial, Environics Analytics, Microsoft Bing, Google Earth.





# Boutique Retail Space in Heritage Building



**SIZE** UNIT 101 - 717 SF  
UNIT 103 - 113 SF

**MONTHLY RENT** UNIT 101 - \$2,600  
UNIT 103 - \$750

**AVAILABILITY** With Notice

Opportunity to lease high-traffic retail space in Downtown Victoria's historic Old Town. The subject space, with frontage on Pandora Avenue, benefits from excellent year-round traffic counts for both vehicles and pedestrians, as well as proximity to a number of thriving businesses. Unit 101 is situated at the corner of Pandora Avenue and Victoria's iconic Fan Tan Alley, which draws a large volume of tourists to the area.

 HIGH-TRAFFIC LOCATION YEAR-ROUND

 HOT-SPOT FOR SPRING/SUMMER TOURISM

 PROXIMITY TO MANY SUCCESSFUL BUSINESSES

 BRICK & BEAM ARCHITECTURE

 OPPORTUNITY TO PURCHASE EQUIPMENT

## AMENITIES

- |                                   |                                 |
|-----------------------------------|---------------------------------|
| <b>1</b> HABIT COFFEE             | <b>11</b> SWAN'S BREWPUB        |
| <b>2</b> MO:LÉ                    | <b>12</b> THE VILLAGE           |
| <b>3</b> VARSHA INDIAN KITCHEN    | <b>13</b> JUSU BAR              |
| <b>4</b> MOUNTAIN EQUIPMENT CO-OP | <b>14</b> BEAN AROUND THE WORLD |
| <b>5</b> SHANZEE'S BISCUIT CAFÉ   | <b>15</b> THE BUBBLE TEA PLACE  |
| <b>6</b> WHISTLE BUOY BREWPUB     | <b>16</b> DON MEE               |
| <b>7</b> GREEN CUISINE            | <b>17</b> FAN TAN CAFÉ          |
| <b>8</b> CAFÉ MEXICO              | <b>18</b> SHIZEN SUSHI          |
| <b>9</b> FUEGO EATERY             | <b>19</b> QV CAFÉ & BAKERY      |
| <b>10</b> THE DRAKE EATERY        | <b>20</b> STARBUCKS             |

## FLOOR PLAN

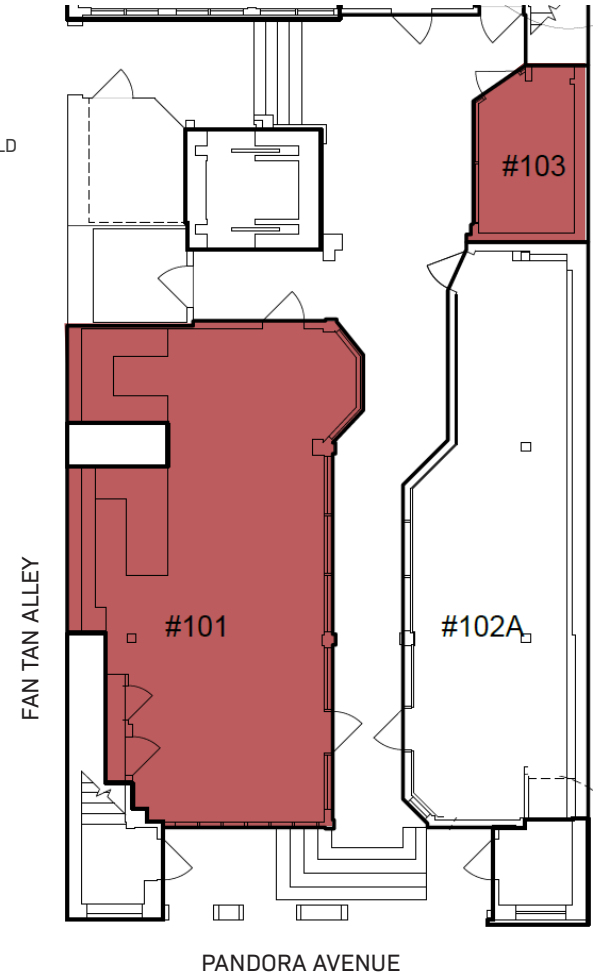

## CONTACT

### NATHANIEL SIMPSON

Sales Associate | Brokerage Services  
250 386 0001  
nathaniel.simpson@cbre.com

### JAMES MURRAY

Sales Representative | Brokerage Services  
250 385 1225  
james.murray@cbre.com