

FOR LEASE

1222 Douglas Street

—
Victoria, BC

10,651 Sq. Ft.

2,591 Sq. Ft.



Flexible Space Options in Downtown Core

- ▶ Prime Downtown Location
- ▶ Well-suited for a variety of office or fitness uses
- ▶ Natural light via windows facing Douglas Street and Yates Street
- ▶ Improvement allowance available to qualified tenants
- ▶ Proximity to major transit arteries
- ▶ Numerous high quality amenities nearby
- ▶ Demising potential
- ▶ High ceilings throughout (13ft)

The Opportunity

Opportunity to lease brand new office space in the center of Victoria's Downtown Core. The subject space is a large floor plate with demising potential on the second floor of 1222 Douglas Street, with windows fronting onto both Douglas and Yates. The space benefits from proximity to a large variety of food & beverage options such as: Starbucks, Azuma Sushi, Fol Epi, Agrius, Yates Street Taphouse, Fatburger, McDonald's, Cactus Club Café, and more.

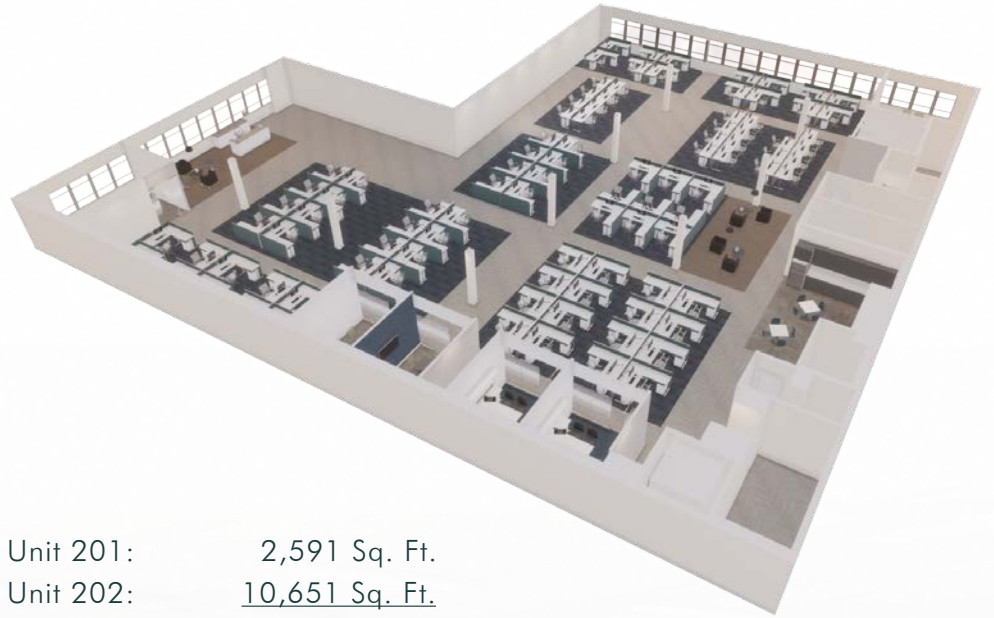

The Details

SIZE

Unit 201: 2,591 Sq. Ft.
Unit 202: 10,651 Sq. Ft.
Total: 13,242 Sq. Ft.

AVAILABLE

Spring 2020

NET RENT

Starting at \$22.00 per Sq. Ft.

ADDITIONAL RENT

\$12.00 per Sq. Ft. (2020 Estimate)



Floor Plan

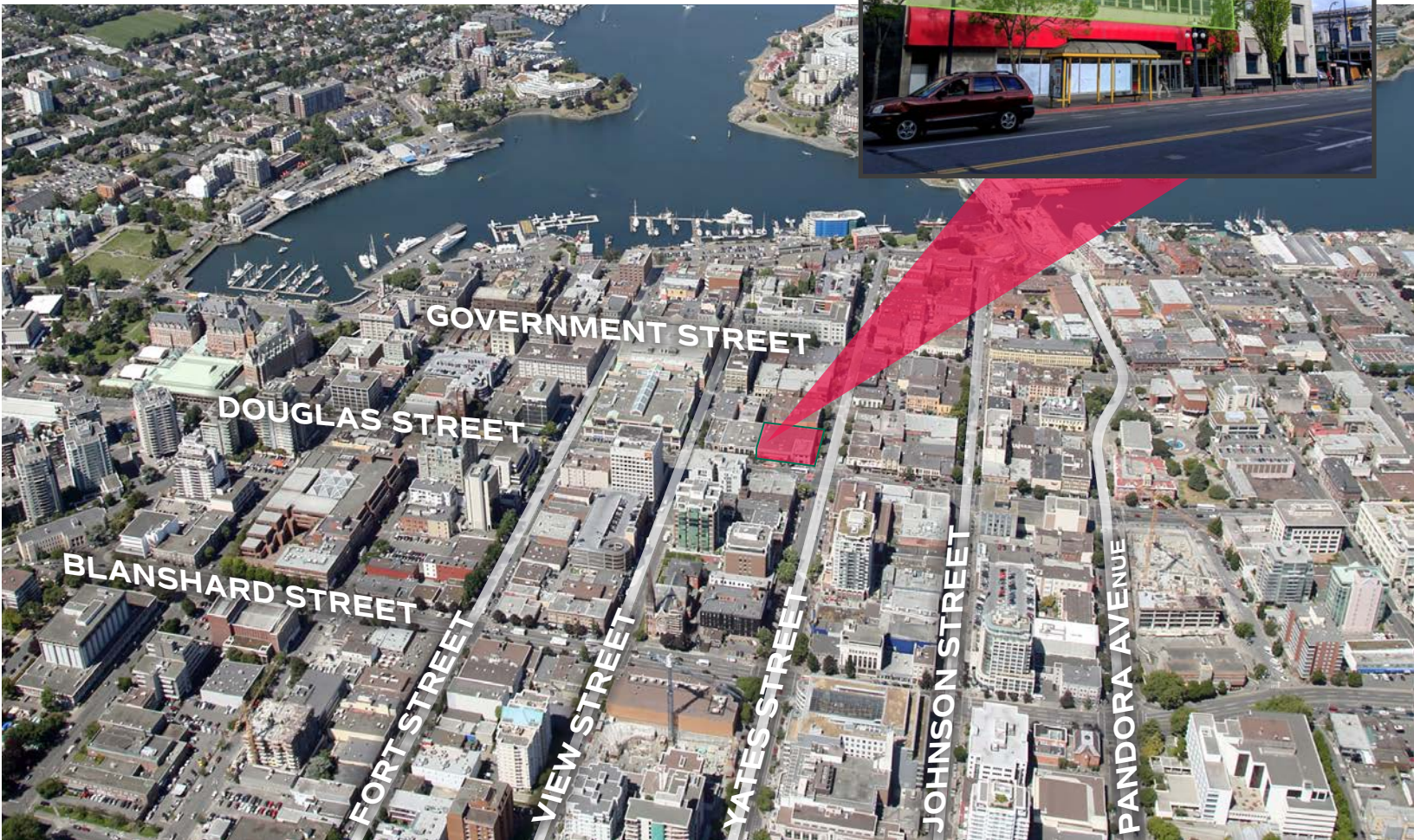
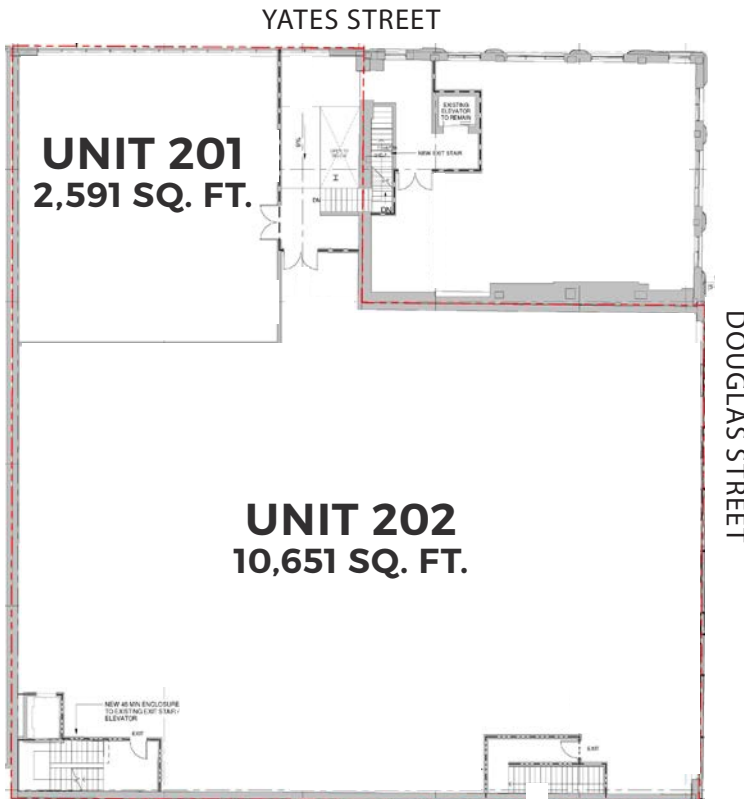

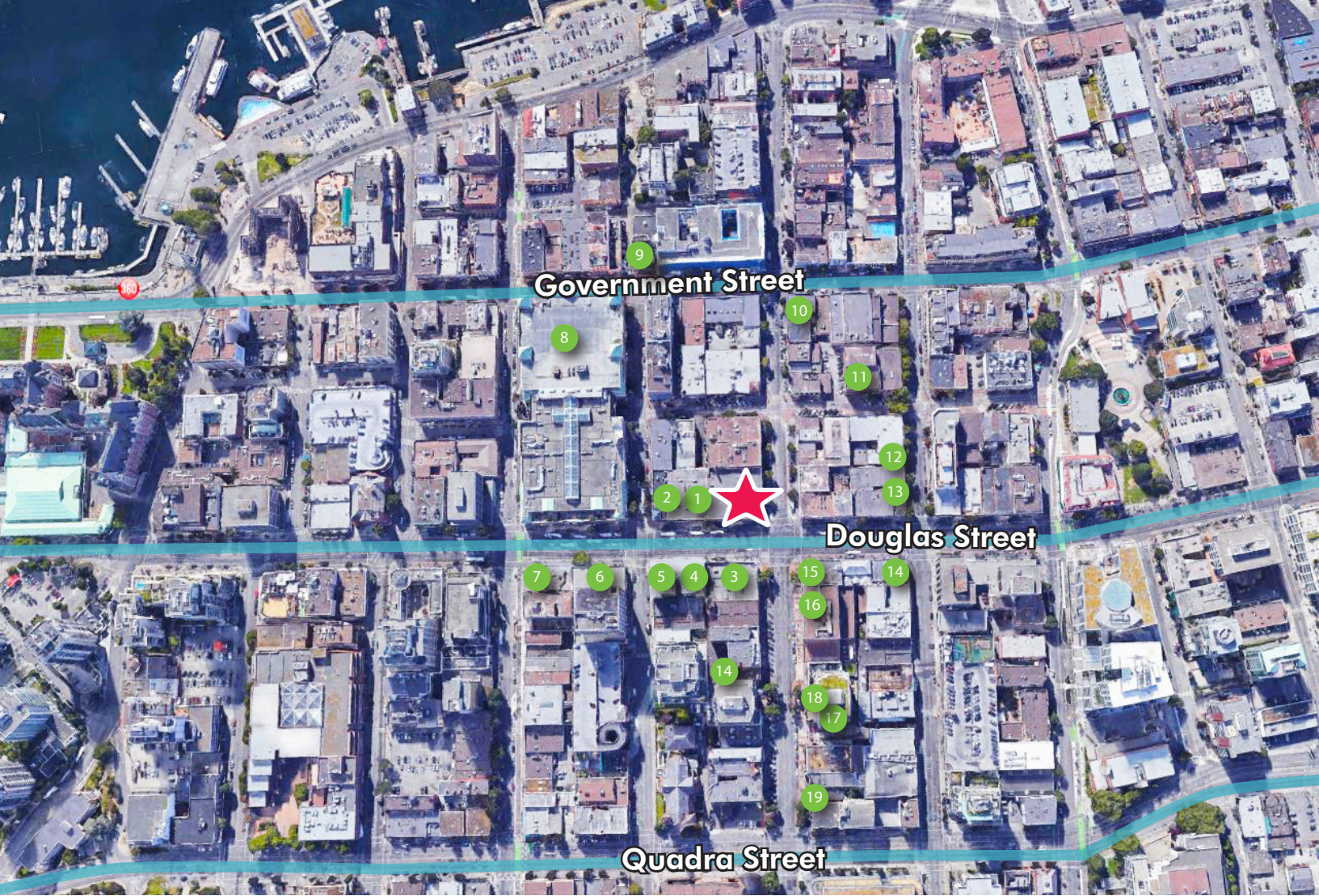

Amenities

- | | | | |
|-------------------------|----------------------|---------------------|--------------------------|
| 1 Shopper's Drug Mart | 6 James Joyce Bistro | 11 Saint Franks | 16 Bulk Barn |
| 2 McDonald's | 7 Cactus Club Café | 12 Sizzling Tandoor | 17 Fol Epi |
| 3 BMO | 8 The Bay Centre | 13 Burger King | 18 Agrius |
| 4 Dolce Vita Coffee Art | 9 Irish Times Pub | 14 7-Eleven | 19 Brickyard Pizza |
| 5 Fatburger | 10 Starbucks | 15 Scotiabank | 20 Yates Street Taphouse |

Contact Us

Ross Marshall
 Personal Real Estate Corporation
 Senior Vice President
 Brokerage Services
 250 386 0004
 ross.marshall@cbre.com

James Murray
 Sales Representative
 Brokerage Services
 250 385 1225
 james.murray@cbre.com



www.cbrevictoria.com | CBRE Limited | 1026 Fort Street, Victoria, BC V8V 3K4 | 250 386 0000

This disclaimer shall apply to CBRE Limited, Real Estate Brokerage, and to all other divisions of the Corporation to include all employees and independent contractors ("CBRE"). The information set out herein, including, without limitation, any projections, ratings, opinions, assumptions and estimates obtained from third parties (the "Information") has not been verified by CBRE and CBRE does not represent, warrant or guarantee the accuracy, correctness and completeness of the Information. CBRE does not accept or assume any responsibility or liability, direct or consequential, for the information or the recipient's reliance upon the information. The recipient of the information should take such steps as the recipient may deem necessary to verify the information prior to placing any reliance upon the information. The information may change and any property described in the information may be withdrawn from the market at any time without notice or obligation to the recipient from CBRE. CBRE and the CBRE logo are the service marks of CBRE Limited and/or its affiliated or related companies in other countries. All other marks displayed on this document are the property of their respective owners. All Rights Reserved. Mapping Sources: Canadian Mapping Services canadamappinginc.com, Data: Spatial, Esri, Esri Analytics, Microsoft Bing, Google Earth.

