

FOR
LEASE

OFFICE/RETAIL SPACE ON OAK BAY AVENUE

#103 - 1625 OAK BAY AVENUE

VICTORIA, BC



Opportunity to lease prime ground-level commercial space on Oak Bay Avenue. The subject space is situated next to Oak Bay Junction and benefits from proximity to numerous high-quality amenities and excellent exposure along Oak Bay Avenue. The space is in shell condition, ready to be built out to tenant specifications and is well-suited for a number of office, medical, and retail uses.

FOR MORE INFORMATION, CONTACT:

JAMES MURRAY

SALES REPRESENTATIVE

BROKERAGE SERVICES

250 385 1225

james.murray@cbre.com

ROSS MARSHALL

PERSONAL REAL ESTATE CORPORATION

SENIOR VICE PRESIDENT | BROKERAGE SERVICES

250 386 0004

ross.marshall@cbre.com

CBRE

#103 - 1625 OAK BAY AVENUE

VICTORIA, BC

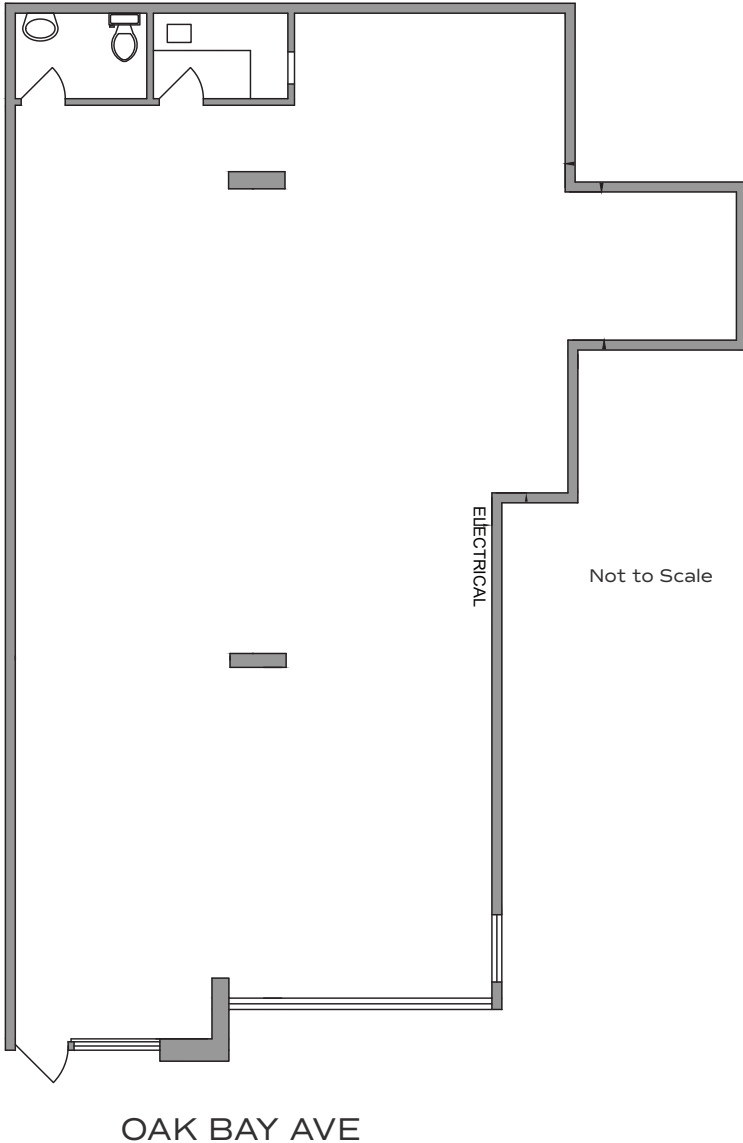

HIGHLIGHTS

- EASY ACCESS OFF OAK BAY AVENUE
- SIGNAGE OPPORTUNITIES
- AMPLE NATURAL LIGHT
- CENTRAL LOCATION
- FULLY AIR-CONDITIONED
- WELL-MAINTAINED BUILDING
- IMPROVEMENT ALLOWANCE NEGOTIABLE

DETAILS

SIZE:	1,798 sq. ft.
NET RENT:	\$17.00 per sq. ft.
ADDITIONAL RENT:	\$10.00 per sq. ft.
AVAILABLE:	Immediately

FOR MORE INFORMATION, CONTACT:

JAMES MURRAY
SALES REPRESENTATIVE
BROKERAGE SERVICES
250 385 1225
james.murray@cbre.com

ROSS MARSHALL
PERSONAL REAL ESTATE CORPORATION
SENIOR VICE PRESIDENT | BROKERAGE SERVICES
250 386 0004
ross.marshall@cbre.com

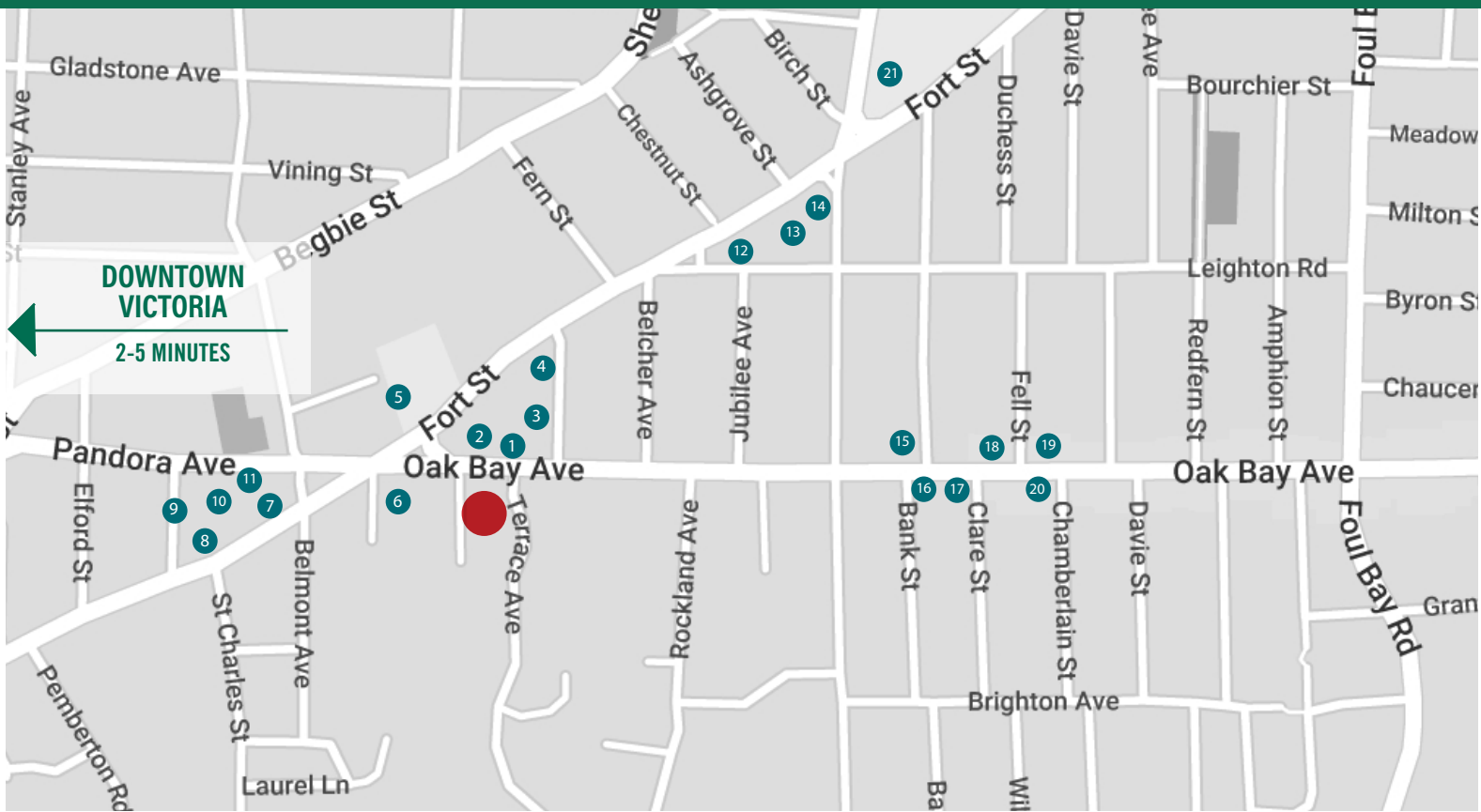

- | | | |
|--------------------------|------------------------|----------------------------|
| 1 Vessel Liquor Store | 8 Shine Café | 15 Oak Bay Pet Clinic |
| 2 Dragon Gate Restaurant | 9 The Tartan Toque | 16 Harry's Flowers |
| 3 Shopper's Drug Mart | 10 Origin Bakery | 17 HSBC |
| 4 Esso | 11 Cosmo's Pizza | 18 The UPS Store |
| 5 Sound Hounds | 12 Christie's Pub | 19 Turnabout Luxury Retail |
| 6 Freddie's Market | 13 Moka House | 20 Good Things Consignment |
| 7 Subway | 14 Forbes IDA Pharmacy | 21 Royal Jubilee Hospital |

FOR MORE INFORMATION, CONTACT:

JAMES MURRAY
 SALES REPRESENTATIVE
 BROKERAGE SERVICES
250 385 1225 | james.murray@cbre.com

ROSS MARSHALL
 PERSONAL REAL ESTATE CORPORATION
 SENIOR VICE PRESIDENT | BROKERAGE SERVICES
250 386 0004 | ross.marshall@cbre.com

CBRE Limited
 1026 Fort Street | Victoria, BC V8V 3K4 | www.cbrevictoria.com

This disclaimer shall apply to CBRE Limited, Real Estate Brokerage, and to all other divisions of the Corporation to include all employees and independent contractors ("CBRE"). The information set out herein, including, without limitation, any projections, images, opinions, assumptions and estimates obtained from third parties (the "Information") has not been verified by CBRE, and CBRE does not represent, warrant or guarantee the accuracy, correctness and completeness of the Information. The recipient of the Information should take such steps as the recipient may deem necessary to verify the information prior to placing any reliance upon the information. The Information may change and any property described in the information may be withdrawn from the market at any time without notice or obligation to the recipient from CBRE. CBRE and the CBRE logo are the service marks of CBRE Limited and/or its affiliated or related companies in other countries. All other marks displayed on this document are the property of their respective owners. All Rights Reserved. Mapping Sources: Canadian Mapping Services canadamapping@cbre.com; DMTI Spatial, Environics Analytics, Microsoft Bing, Google Earth.

