

# FOR SUBLEASE FULL FLOOR OFFICE SPACE IN UPPER HARBOUR PLACE

300 - 655 TYEE ROAD | VICTORIA, BC



FOR MORE INFORMATION PLEASE CONTACT:

**Ross Marshall**  
Personal Real Estate Corporation  
Senior Vice President  
Brokerage Services  
250 386 0004  
ross.marshall@cbre.com

**Nathaniel Simpson**  
Sales Associate  
Brokerage Services  
250 386 0001  
nathaniel.simpson@cbre.com

**Scott MacDonald**  
Vice President  
Brokerage Services  
604 998 6020  
scott.macdonald@am.jll.com



# FOR SUBLEASE FULL FLOOR OFFICE SPACE IN UPPER HARBOUR PLACE

300 - 655 TYEE ROAD | VICTORIA, BC

## OPPORTUNITY

To occupy 20,987 sq. ft. of prime waterfront office space in Upper Harbour Place, a Class A office building with harbour views.

## LOCATION

The subject property is situated in a harbour location, on Tye Road between Bay Street and Harbour Road. The premises are adjacent to the Westside Village Shopping Centre offering tenants access to amenities such as Save on Foods, Starbucks, numerous restaurants with Goodlife Fitness located on the main floor of the subject property.

## SUBLEASE RATE

Contact Listing Agent

## OPERATING COSTS & TAXES

\$15.52 per sq. ft. (estimate)

## SUBLEASE TERM

Until April 29, 2022

## AVAILABLE

Contact Listing Agent

## PARKING

38 reserved stalls  
Additional unreserved stalls available upon request

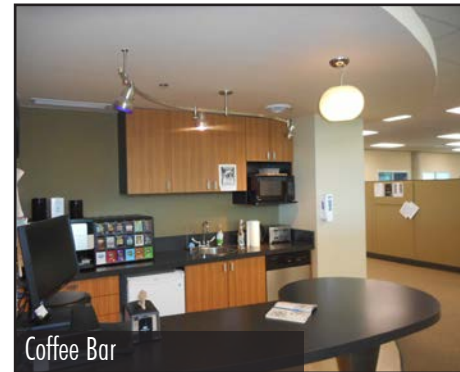

Coffee Bar



Kitchen & Lounge



Patio



Conference Room



Harbour Views

Transit Score



Good Transit  
63

Bike Score



Biker's Paradise  
100

Walk Score



Very Walkable  
85

# FOR SUBLEASE FULL FLOOR OFFICE SPACE IN UPPER HARBOUR PLACE

300 - 655 TYEE ROAD | VICTORIA, BC

## FEATURES

- ✓ Modern glass and concrete office building
- ✓ Floor to ceiling glazing
- ✓ Private offices with harbour views - 1 with private patio
- ✓ Full kitchen with lounge area
- ✓ Employee coffee bar
- ✓ Mens & ladies washrooms - 3 with showers
- ✓ Large conference room, meeting rooms, server room
- ✓ Fiber optic cabling
- ✓ Elevator access
- ✓ Air-conditioned
- ✓ On-site Goodlife Fitness facility

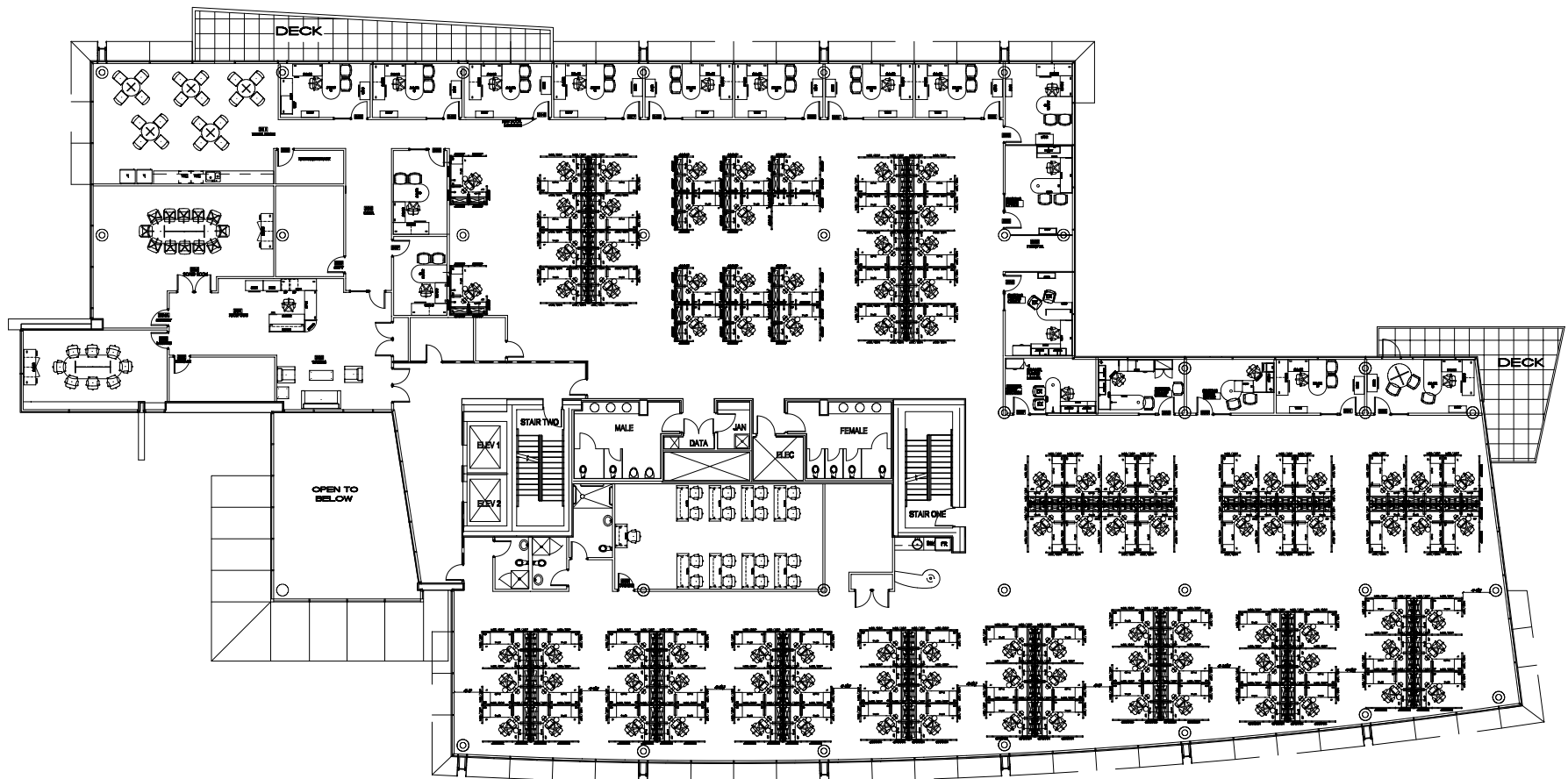

# FOR SUBLEASE FULL FLOOR OFFICE SPACE IN UPPER HARBOUR PLACE

300 - 655 TYEE ROAD | VICTORIA, BC



## FOR MORE INFORMATION PLEASE CONTACT:

**Ross Marshall**  
Personal Real Estate Corporation  
Senior Vice President  
Brokerage Services  
250 386 0004  
ross.marshall@cbre.com

**Nathaniel Simpson**  
Sales Associate  
Brokerage Services  
250 386 0001  
nathaniel.simpson@cbre.com

**Scott MacDonald**  
Vice President  
Brokerage Services  
604 998 6020  
scott.macdonald@am.jll.com

CBRE Limited | 1026 Fort Street | Victoria, BC | Tel: 250 386 0000 | [www.cbre.ca](http://www.cbre.ca) | [www.cbrevictoria.com](http://www.cbrevictoria.com)

This disclaimer shall apply to CBRE Limited, Real Estate Brokerage, and to all other divisions of the Corporation; to include all employees and independent contractors ("CBRE"). The information set out herein, including, without limitation, any projections, images, opinions, assumptions and estimates obtained from third parties (the "Information") has not been verified by CBRE, and CBRE does not represent, warrant or guarantee the accuracy, correctness and completeness of the Information. CBRE does not accept or assume any responsibility or liability, direct or consequential, for the Information or the recipient's reliance upon the Information. The recipient of the Information should take such steps as the recipient may deem necessary to verify the Information prior to placing any reliance upon the Information. The Information may change and any property described in the Information may be withdrawn from the market at any time without notice or obligation to the recipient from CBRE. CBRE and the CBRE logo are the service marks of CBRE Limited and/or its affiliated or related companies in other countries. All other marks displayed on this document are the property of their respective owners. All Rights Reserved.

Mapping Sources: Canadian Mapping Services [canadamapping@cbre.com](mailto:canadamapping@cbre.com); DMTI Spatial, EnviroNics Analytics, Microsoft Bing, Google Earth.

© 2018 Jones Lang LaSalle IP, Inc. All rights reserved. All information contained herein is from sources deemed reliable; however, no representation or warranty is made to the accuracy thereof. E. & O. E. Jones Lang LaSalle Real Estate Services, Inc. Real Estate Brokerage \* Personal Real Estate Corporation | [www.jll.ca](http://www.jll.ca)

