

FOR LEASE: RETAIL/OFFICE SPACE IN BROUGHTON SQUARE

623, 625 BROUGHTON STREET, 622 COURTNEY STREET & 911 GORDON STREET | VICTORIA, BC



FOR MORE INFORMATION PLEASE CONTACT:

Chris Rust

Vice President
Brokerage Services
250 386 0005
chris.rust@cbre.com

Nathaniel Simpson

Sales Associate
Brokerage Services
250 386 0001
nathaniel.simpson@cbre.com

CBRE

FOR LEASE: RETAIL/OFFICE SPACE IN BROUGHTON SQUARE

623, 625 BROUGHTON STREET, 622 COURTNEY STREET & 911 GORDON STREET | VICTORIA, BC

623 BROUGHTON STREET

RENTABLE AREA:

732 sq. ft.

LEASE RATE:

\$29.00 per sq. ft.

OPERATING COSTS & TAXES:

\$15.91 per sq. ft. (Estimate)

AVAILABLE:

Immediately

FEATURES:

- ✓ In suite washroom
- ✓ Hardwood flooring
- ✓ Open work area with back storage
- ✓ Large storefront windows
- ✓ Signage opportunity
- ✓ Ample parking in building parkade



FLOORPLAN:

BROUGHTON STREET

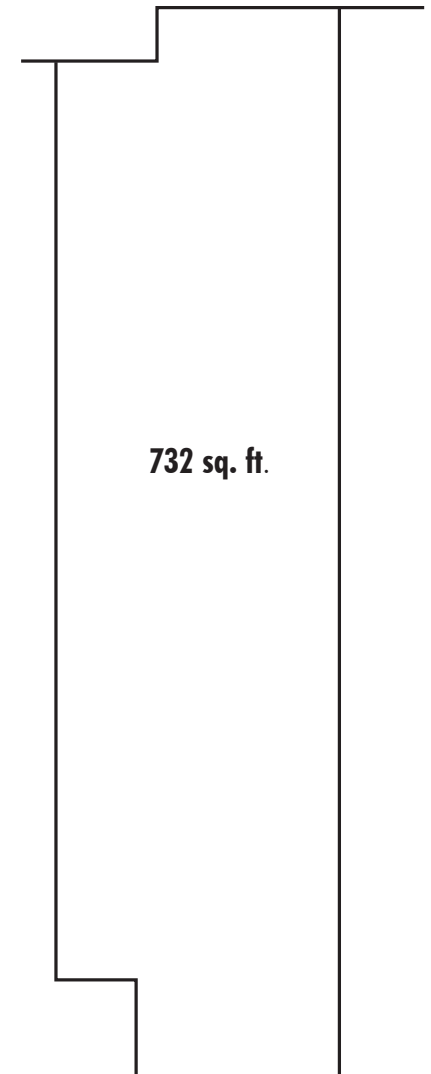

*Floorplan not to scale.

FOR LEASE: RETAIL/OFFICE SPACE IN BROUGHTON SQUARE

623, 625 BROUGHTON STREET, 622 COURTNEY STREET & 911 GORDON STREET | VICTORIA, BC

625 BROUGHTON STREET

RENTABLE AREA:

891 sq. ft.

LEASE RATE:

\$25.00 per sq. ft.

OPERATING COSTS & TAXES:

\$15.91 per sq. ft. (Estimate)

AVAILABLE:

Immediately

FEATURES:

- ✓ Mostly open concept with back storage area
- ✓ In-suite washroom
- ✓ Large storefront windows
- ✓ Central downtown location
- ✓ High pedestrian traffic
- ✓ Ample parking in building parkade



FLOORPLAN:

BROUGHTON STREET

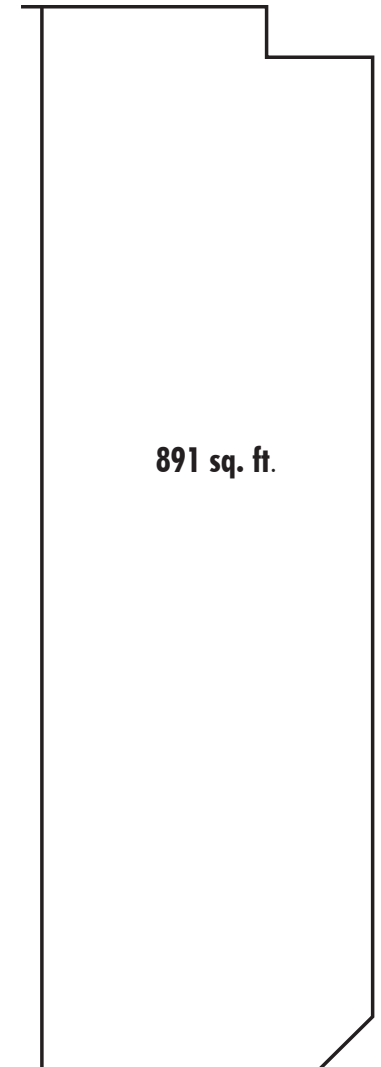

**Floorplan not to scale.*

FOR LEASE: RETAIL/OFFICE SPACE IN BROUGHTON SQUARE

623, 625 BROUGHTON STREET, 622 COURTNEY STREET & 911 GORDON STREET | VICTORIA, BC

622 COURTNEY STREET

RENTABLE AREA:

1,231 sq. ft.

LEASE RATE:

Contact Listing Agent

OPERATING COSTS & TAXES:

\$15.91 per sq. ft. (Estimate)

AVAILABLE:

August 1, 2019

FEATURES:

- ✓ Open storefront area with large windows
- ✓ Central downtown location
- ✓ High pedestrian traffic
- ✓ Good signage opportunity
- ✓ Ample parking in building parkade



FOR LEASE: RETAIL/OFFICE SPACE IN BROUGHTON SQUARE

623, 625 BROUGHTON STREET, 622 COURTNEY STREET & 911 GORDON STREET | VICTORIA, BC

FLOORPLAN:

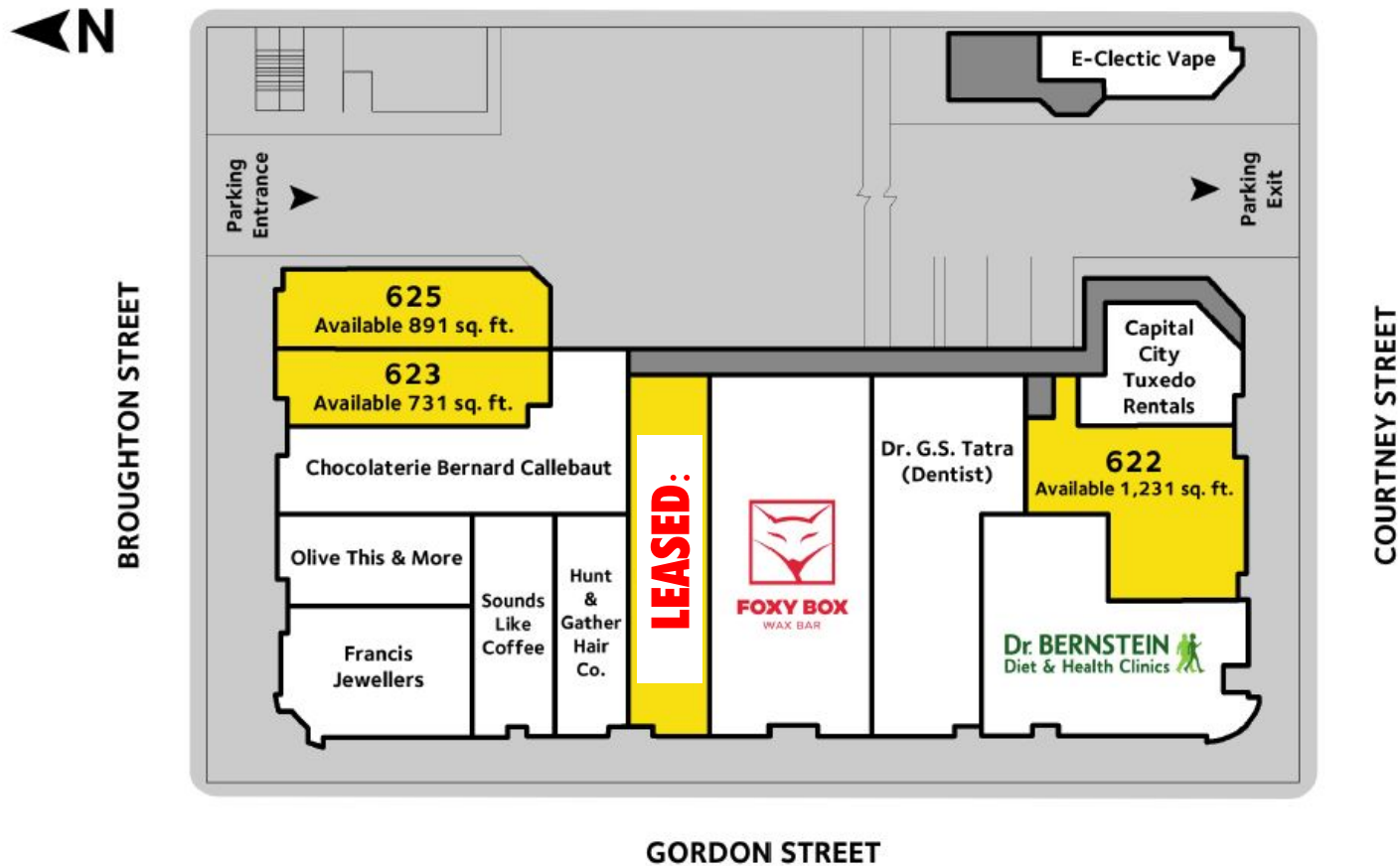

FOR LEASE: RETAIL/OFFICE SPACE IN BROUGHTON SQUARE

623, 625 BROUGHTON STREET, 622 COURTNEY STREET & 911 GORDON STREET | VICTORIA, BC

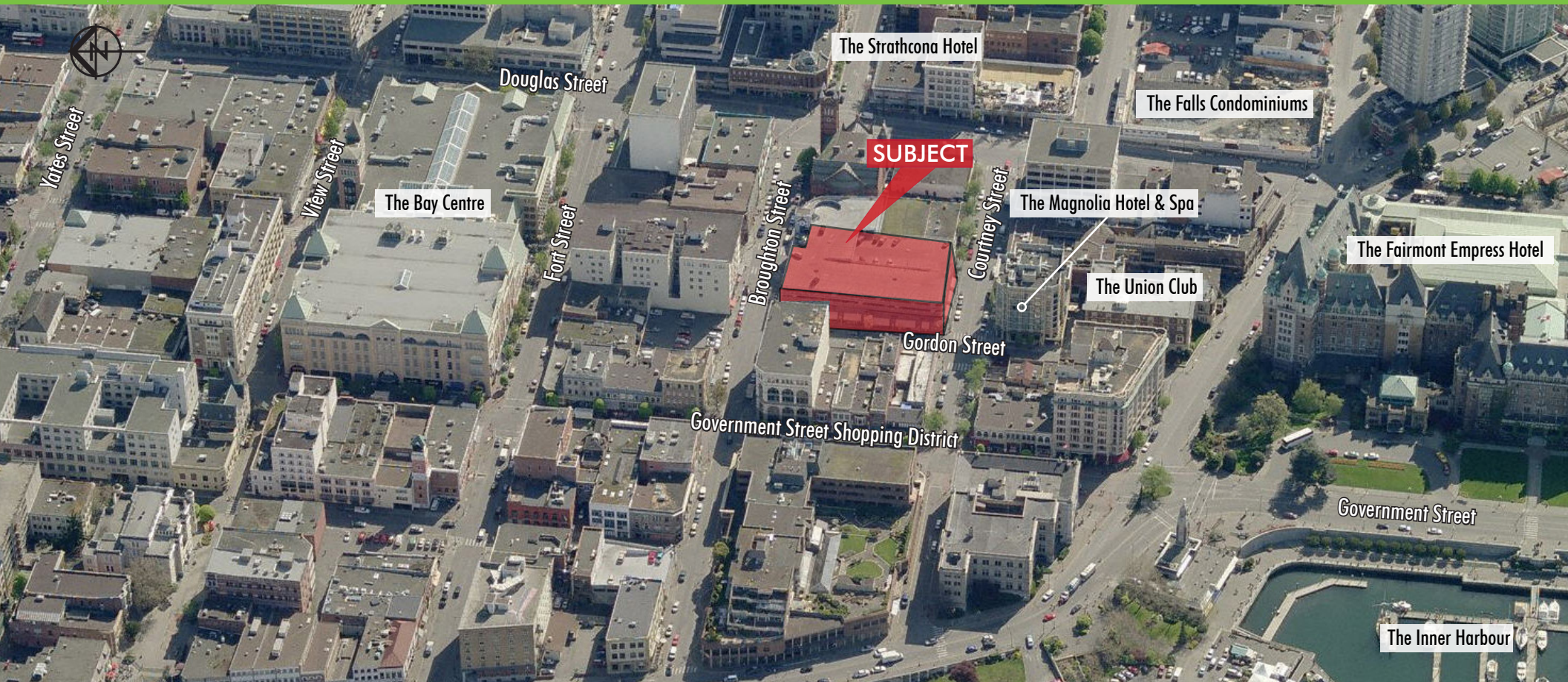

FOR MORE INFORMATION PLEASE CONTACT:

Chris Rust

Vice President
Brokerage Services
250 386 0005
chris.rust@cbre.com

Nathaniel Simpson

Sales Associate
Brokerage Services
250 386 0001
nathaniel.simpson@cbre.com

CBRE Limited | 1026 Fort Street | Victoria, BC | Tel: 250 386 0000 | www.cbrevictoria.com

This disclaimer shall apply to CBRE Limited, Real Estate Brokerage, and to all other divisions of the Corporation; to include all employees and independent contractors ("CBRE"). The information set out herein, including, without limitation, any projections, images, opinions, assumptions and estimates obtained from third parties (the "Information") has not been verified by CBRE, and CBRE does not represent, warrant or guarantee the accuracy, correctness and completeness of the Information. CBRE does not accept or assume any responsibility or liability, direct or consequential, for the Information or the recipient's reliance upon the Information. The recipient of the Information should take such steps as the recipient may deem necessary to verify the Information prior to placing any reliance upon the Information. The Information may change and any property described in the Information may be withdrawn from the market at any time without notice or obligation to the recipient from CBRE. CBRE and the CBRE logo are the service marks of CBRE Limited and/or its affiliated or related companies in other countries. All other marks displayed on this document are the property of their respective owners. All Rights Reserved. Mapping Sources: Canadian Mapping Services canadamapping@cbre.com; DMTI Spatial, Enverics Analytics, Microsoft Bing, Google Earth.

CBRE